

ASSOCIATION OF STATE FLOODPLAIN MANAGERS 2017 POCKET GUIDE



ASFPM 2017 CONFERENCE TEAM April 30 - May 5, 2017, Kansas City

Local Host Team

Tom Morey, CFM, Team Leader
Jan Whipple, CFM, Volunteers Coordinator

Team Captains: Todd Tucker, Karen McHugh, CFM, Linda Olsen, CFM, &
Jason Schneider, PE, PMP, CFM

Program Chair

Steve McMaster, CFM, Ideation, Inc.

Conference Direction Team

Jenny Seffrood, *Event Planner*
Diane Brown, *Outreach Specialist*
Anita Larson, *Certification Coordinator & Registration*
Jason Schneeberger, *IT Manager*
Kait Laufenberg, CFM, *Training & Chapter Coordinator*

ASFPM Staff

Chad Berginnis, CFM <i>Executive Director</i>	Ingrid Wadsworth, CFM <i>Deputy Director</i>	Larry Larson, PE, CFM <i>Sr. Policy Advisor</i>
Jim Dunham <i>Member Services Coordinator</i>	Suzanne Gillingham <i>Financial Manager</i>	
Nancy Dunham <i>Certification Program Assistant</i>	Michele Mihalovich <i>Public Information Officer</i>	

ASFPM Flood Science Center

Bill Brown, PE, <i>Center Director</i>	Jeff Stone, GISP, CFM <i>Senior Project Manager</i>
Bridget Faust <i>Project Research Specialist</i>	Robyn Wiseman, CFM <i>Research Scientist</i>
Jason Hochschild <i>GIS & Research Analyst</i>	Melissa Haig, MLIS <i>Research Librarian</i>
Alan Lulloff, PE, CFM, <i>Chief Scientist</i>	

ASFPM Executive Office

575 D'Onofrio Drive, Suite 200, Madison, WI 53719
608-828-3000, Fax: 828-6319 | www.floods.org

i	Conference Team
1	Table of Contents
2	Welcome and General Information
3	Meeting Room Assignments

Conference Sponsors

4	Our Sponsors
---------	--------------

The Conference Program

14	Sunday
16	Monday
19	Tuesday
34	Wednesday
48	Thursday
60	Friday
Center Spread (pg. 30-31) Meeting Rooms Floor Plans	

* *Indicates events are targeted for State Floodplain
Managers & Hazard Mitigation Officers*

\$ *Indicates fee-based workshops and tours offered a la carte
(Note: guests must register and pay the \$25 guest registration
fee in order to participate in any conference event)*

Carry a smart phone or tablet?

Check out the mobile version of
the conference program at:
<http://bit.ly/2nxvtOY>

WELCOME!

Welcome to the 41st annual conference of the Association of State Floodplain Managers! We're glad that you could join us in Kansas City. This Pocket Guide will help you get the most out of your week, so be sure to keep it close at hand. **YOUR NAME BADGE IS REQUIRED TO GET YOU INTO EVERYTHING YOU REGISTERED TO ATTEND AND YOU MUST WEAR IT ALL WEEK IN ORDER TO BE ADMITTED.** If you have questions, see ASFPM staff at the registration desk or ask one of the local host volunteers - they will be wearing white volunteer shirts while on duty. Please enjoy your week as you delve into the most comprehensive floodplain management training & networking opportunity in the country!

Registration Desk *In front of L2: 2504-B*
The registration desk is located on the second floor of Kansas City Convention Center (KCCC) in front of 2504-B. It will be open to serve you from 10-7:30 Sunday, 7-5 Monday-Thursday, and 7:30-noon Friday.

Speaker Prep Lounge *L2: 2505-A*
Conference Program Coordinator Steve McMaster, AV Coordinator Jason Schneeberger, and their volunteers will be available to assist you with program and AV concerns throughout the week. Speakers may practice their presentations here and get them queued up for the sessions.

Local Host / Volunteer HQ *L2: 2505-B*
Jan Whipple and the local host team, consisting of KAFM & MFSMA members and floodplain managers from throughout Region VII, coordinate the volunteers required for the many duties it takes to help operate the conference.

First Timers Orientation will be held Sunday at 3:00p and 5:00p, Monday at 10:00a and 3:00p, and Tuesday at 10:00a. New attendees should plan to attend one of these 15-minute sessions to help you get the most out of the week! Meets near the registration desk.

Message Board *Reg*
The message board will display special notices, schedule or room changes, phone messages, job postings, menus, ticket exchanges, ride-sharing, and other information. It is located near the registration desk.

MEETING ROOM ASSIGNMENTS
Most on-site conference activities take place at the Kansas City Convention Center. The location of each session is listed to the right of the event name. The technical concurrent session program follows eight general themes during those blocks Tuesday through Thursday.

#	Track Title	Room
1	Mitigation	L2: 2502-A
2	Policy	L2: 2502-B
3	Modeling	L2: 2503-A
4	Disaster / Watershed	L2: 2503-B
5	Mapping	L3: 3501-A
6	Dams & Levees	L3: 3501-B
7	Training & Outreach	L3: 3501-C
8	Stormwater	L3: 3501-D
9	State FPM & Hazard Mitigation (Wed. only)	L2: 2504-A

Meeting Room Abbreviations

Kansas City Convention Center	KCCC
Level 2	L2
Level 3	L3
Marriott Hotel	Mar
2nd Floor, KCCC, Ballroom A & B	BR
2nd Floor, KCCC, Ballroom C & D	Exh
2nd Floor, KCCC, Registration (2504-B)	Reg

Field Tours Departure Point *Bus*
Bus loading area: on 14th Street between Central St. and Wyandotte St.

Our Sponsors



AECOM
Built to deliver a better world

Find out about the
AECOM Showcase, our sessions,
and other **ASFPM** activities

AECOMasfpm.com



listen. think. deliver.

Water
Environment
Transportation
Energy
Facilities

CDM Smith is helping clients around the world create resilient communities that are able to respond and adapt to changing conditions.

CDM Smith
cdmsmith.com

Proud to be a Gold Sponsor of ASFPM 2017



Michael Baker
INTERNATIONAL

We Make a Difference

Creating Resiliency and Sustainability for a Changing World

Water Resources
Community Planning
Hazard Mitigation
Transportation Services
Architecture
Geospatial and LiDAR

Jeff Sparrow, PE., CFM, Senior Vice President
(703) 317-6288 • jsparrow@mbakerintl.com

MTBAKERINTL.COM



compass

Improving our World by Identifying Hazards, Interpreting Risks, and Integrating Mitigation

For more information, please contact:
Lillian Robison • lillian.robison@cdmsmith.com
Tim Hillier • hillier@cdmsmith.com

Water Surface Elevation	
10% Annual Chance	55.2' NGD
4% Annual Chance	51.7' NGD
2% Annual Chance	50.2' NGD
1% Annual Chance	48.9' NGD
0.2% Annual Chance	47.8' NGD

1% Annual Chance Elevation: 48.9' NGD

Flood Depth: 3.5'



**Committed to delivering
resilience solutions that
strengthen communities**

www.dewberry.com



OLSSON[®]
ASSOCIATES

National Experience. Local Relationships.

www.olssonassociates.com

▶ f in @olsson_assoc

HALFF[®] | SMARTER SOLUTIONS

MEMBER OF COMPASS PTS JV

ENGINEERS ■ ARCHITECTS ■ SCIENTISTS
PLANNERS ■ SURVEYORS



www.halff.com | info@halff.com | 1-800-HALFF US

f in

Tt TETRA TECH

Leading with Science

For the past 13 years *ENR* has ranked Tetra Tech #1 in water. Tetra Tech provides innovative, sustainable solutions for every phase of the water cycle.



tetrattech.com



- Risk Communications
- Behavioral Science
- Creative Technology
- Community Engagement

At Ogilvy, we tackle society's biggest challenges with insights, ideas and influence.

Enter to win a Google virtual reality headset!
Drop off your business card and learn more about us.

www.ogilvypr.com

Meg Bartow, Risk Communications
meg.bartow@ogilvy.com | 202-729-4196

Save the Date



NMF PW

National Mitigation &
FloodProofing Workshop
August 14-17, 2017 | South Iselin, NJ

Titanium

Michael Baker

INTERNATIONAL



FEMA

Platinum

ATKINS



Stantec



TETRA TECH

AECOM

Gold



Silver



ILC DOVER
creating what's next™



Bronze



Nickel

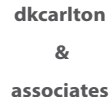

Booz | Allen | Hamilton

Local Agency Sponsors

Kansas Association for Floodplain Management

Missouri Floodplain & Stormwater Managers Association

Visit KC

10:00-7:30	Registration Desk Hours	<i>Reg</i>
7:00-8:00	ASFPM Board Member Breakfast (<i>Invitation Only</i>)	<i>L2: 2503-B</i>
8:00-12:30	ASFPM Board Meeting	<i>L2: 2502-B</i>
12:30-2:00	ASFPM Board & Committee Co-Chairs Luncheon (<i>Invitation Only</i>)	<i>L2: 2503-B</i>
2:00-5:30	ASFPM Committee Chairs Mtg. (<i>Invitation Only</i>)	<i>L2: 2502-B</i>
9:00-5:00	<u>TRAINING WORKSHOPS (\$)</u> Floodplain Mgmt. 101 (\$80)	<i>L2: 2504-A</i> <i>Instructors: Jennifer Marcy, CFM, Atkins; Heidi Carlin, CFM & Shanna Michael, GISP, CFM, AECOM</i>
1:00-3:00	* Building Codes & Stds.: Recent Changes & FEMA Policies (\$45)	<i>L3: 3501-C</i> <i>Instructors: John Ingargiola, EI, CBO, CFM, FEMA HQ, Rebecca Quinn, CFM, RCQuinn Consulting</i>
1:00-5:00	Getting Familiar with the USGS Flood-data Toolbox (\$45)	<i>L3: 3501-B</i> <i>Instructor: Marie Peppler, USGS</i>
1:00-5:00	* Hurricane Awareness	<i>L3: 3501-A</i> <i>Instructors: Cheryl Nelson & Allison Hardin, CFM, NDPTC</i>
1:00-4:30	<u>TECHNICAL/GUEST TOUR (\$)</u> WWI Memorial/Museum 100 Year Anniv. (\$50)	<i>Bus</i>
3:00-3:15	First Timers Orientation	<i>Reg</i>
5:00-5:15	First Timers Orientation	<i>Reg</i>

5:30-6:30	State Floodplain Mgrs./Hazard Mitigation Officers, & ASFPM Board Members Meet & Greet (<i>Invitation Only</i>)
7:30-10:00	Welcome Fest <i>BR-A</i> Hosted by: KAFM, MfSMA, & Local / Chapter Sponsors. See old friends & meet new ones at this Kansas City tailgate inspired event! Wear your favorite sports jersey. The tailgate will be serving small bites and cold drinks. ATTENDEE & GUEST NAME BADGES MUST BE PRESENTED FOR ADMISSION.

7:00-5:00 **Registration Desk Hours** *Reg*
 7:30-5:00 **Speaker Prep Lounge Hours** *L2: 2505-A*

TRAINING WORKSHOPS (\$)

8:00-5:00 *** Social Media for Disaster Response & Recovery** *Mar: Truman A-B*
Instructors: Kevin Sur & Allison Hardin, CFM, NDPTC

8:00-Noon **Floodproofing: Not as Cut & Dry as You Think (\$45)** *L3: 3501-B*
Instructors: Daniel Bass, R.A., CFM, FEMA HQ; Adam Reeder, PE, CFM, CDM Smith

8:00-Noon *** State Floodplain Mgr. 1 on 1 (Invitation Only)** *L3: 3501-E*
Instructor: Al Goodman, Jr., CFM, AWG Consulting

10:00-Noon *** FEMA Benefit-Cost Analysis & Climate Change: Current Guidance (\$45)** *L3: 3501-A*
Instructors: John Squerciati, PE, CFM & Juan Nieves, EIT, CFM, Dewberry; Jody Springer & Rebecca Carroll, AICP, FEMA HQ

8:00-9:00 **NATIONAL POLICY DISCUSSIONS**
General Policy Issues Overview & Legislative Update *L2: 2502-A*

9:00-9:30 **Break** *Lobby: BR*

9:30-12:00 **NATIONAL POLICY DISCUSSIONS**
 Floodplain Regulations *L3: 3501-D*
 International Issues *L3: 3501-C*
 Map. & Eng. Standards *L2: 2502-A*
 Mitigation *L2: 2502-B*
 Professional Devel./CFM Prog *L2: 2503-A*
 Training & Outreach *L2: 2503-B*

10:00-10:15 **First Timers Orientation** *Reg*

Noon-1:00 **Lunch on your own** (*on-site concessions*)

TRAINING WORKSHOPS (\$)

1:00-3:00 *** Risk MAP: Through the Eyes of the Community (\$45)** *L3: 3501-E*
Instructors: Brock Remus, CFM, Atkins; Brian Killen, CFM, Stantec

1:00-5:00 **Flow Simulation Using 2D Unsteady Model in HEC-RAS 5.03 (\$45)** *L3: 3501-B*
Instructor: Prof. Jennifer Duan, PE, University of Arizona

1:00-5:00 **Succeeding in the NFIP (\$45)** *L3: 3501-A*
Instructor: Wendy Lathrop, PLS, CFM, Cadastral Consulting

1:00-5:00 **TECHNICAL/GUEST TOUR (\$)**
Turkey Creek Technical Tour *Bus*

NATIONAL POLICY DISCUSSIONS

Arid Regions *L3: 3501-C*
 Coastal Issues *L3: 3501-D*
 Flood Insurance *L2: 2502-A*
 Higher Education *L2: 2503-A*
 Nonstructural Floodproofing *L2: 2503-B*
 Stormwater Mgmt., No Adverse Impact, & Natural & Beneficial Functions *L2: 2502-B*

3:00-3:15 **First Timers Orientation** *Reg*

3:00-5:00 **Cooperating Technical Partners (CTP) Conversation** *L3: 3501-G*

3:30-4:00 **Break** *Lobby: BR*

4:00-5:00 **ASFPM Members Meeting** *L2: 2502-A*

4:00-7:00	CFM Exam	<u>L2: 2504-A</u>	7:00-8:30	Early Morning Coffee Break	<u>Exh</u>
5:00-7:00	Exhibits Grand Opening/Social	<u>Exh</u>	7:00-7:15p	Exhibit Hall Hours	<u>Exh</u>
5:00-7:00	Silent Auction	<u>Exh</u>	7:00-5:00	Registration Desk Hours	<u>Reg</u>
	15 th Annual FUNdraising activity for the ASFPM Foundation		7:30-5:00	Speaker Prep Lounge Hours	<u>L2: 2505-A</u>
7:00....	Dinner on your own, enjoy Kansas City!		8:30-10:00	<u>PLENARY SESSION 1</u>	<u>BR</u>
				Welcome Address	
				Managing Flood Risk in the Heartland	
				1. Evolution of Innovative Stormwater Management: Lee Kellenberger,	
				Stormwater Management Program, Johnson County, KS	
				2. Programs, Projects & Training to Reduce Flood Losses: Randy Behm,	
				PE, CFM, USACE, National Nonstructural FloodProofing Committee	
				3. Midwest Mitigation Practices in the Face of Great Floods: Paul Osman,	
				CFM, Manager, NFIP & Floodplain Mgmt., Office of Water Resources, Illinois DNR	
				Moderator: Ceil Strauss, CFM, ASFPM Chair, Minnesota DNR	
			10:00-10:15	First Timers Orientation	<u>Reg</u>
			10:00-10:30	Break, Exhibits, Silent Auction	<u>Exh</u>
			10:30-Noon	<u>CONCURRENT SESSION A</u>	
		A1		Assessments to Evaluate & Prioritize Mitigation Options	<u>L2: 2502-A</u>
				Moderator: Michael Powell, CFM, ASFPM Regulations Cmte. Co-Chair, Delaware DNREC	
				Implementing a Proactive Land Acquisition Framework for Flood Risk Reduction. Sam Brody, PhD, Texas A&M University	

A1 (cont.) **Owen County, IN Transportation Vulnerability Assessment.** *L2: 2502-A*
David Knipe, PE,
CFM, Indiana DNR
Nonstructural Assessment in the Little Apple. Brian Rast, PE, PMP, CFM, USACE,
Institute for Water Resources

A2 **The Changing Face of Floodplain Mgmt. Policy** *L2: 2502-B*
Moderator: Joy Duperault, CFM,
Massachusetts DCR
Climate Change Policy Update: Overview of Federal Agency Responses to EO13690 & the Federal Flood Risk Mgmt. Standard.
Shane Parson, PhD, PE, CFM, AECOM
Levees & NFIP Reauthorization: Some Hot Topics & What to Watch. Kyle Gilster, Esq.,
Husch Blackwell
The Climate Science Approach in Floodplain Mgmt. Kristina Murphy, EI, CFM, DuPage
County, IL

A3 **Modeling a Wave of Coastal Conditions** *L2: 2503-A*
Moderator: Jeffrey Tabar, PE, D.CE, Stantec
Lake Michigan ADCIRC+SWAN Modeling for Flood Risk Analysis. Jeffrey Tabar, PE, D.CE,
STARR II
Gowanus Canal & Newtown Creek Storm Surge Barrier. Jonathan Goldstick, PE, CH2M
Wave Runup: Does it Really Determine Floodplains? Corrections to Common Errors in Modeling & Mapping of Wave Runup & Overtopping. Joe Faries, PE, CFM, Stantec

A4 **Nature-based Flood Reduction & Ecosystem Services** *L2: 2503-B*
Moderator: Rebecca Pfeiffer, CFM, ASFP
Natural & Beneficial Funct. Cmte. Co-Chair,
Vermont Agency of Natural Res.
Naturally Resilient Communities: Using Nature & Nature-based Solutions to Address Flooding. Nathan Woiwode, The Nature
Conservancy
Ecosystem Service Valuation Tools for Floodplains. Mark Healy, Southern Illinois
University
From Headwaters to Downtown: Informing Floodplain Restoration Priorities with Spatial Analytics & Ecosystem Service Valuation.
Zachary Christin, Earth Economics

A5 **The Case for Quality Data** *L3: 3501-A*
Moderator: Marc Pearson, GISP, CFM, Stantec
Quantifying the Impact of 20-year Flood Frequency on Land Cover Change Type.
David Alexander, PhD, FEMA HQ
Extreme Precipitation Analysis vs. Archived Storms in a Digital Age. Marian Baker, CFM,
NOAA, NWS
An Innovative Approach for Determining Storm Event Rainfall Probabilities: Case Study Hurricanes Matthew & Joaquin.
Neal Banerjee, PE, CFM, ESP

A6 **Communication About Residual Risk for Dams & Levees** *L3: 3501-B*
Moderator: Michael Hanke, CDM Smith
The Art of Information Sharing. James
Demby, Jr., PE, FEMA HQ

A6 (cont.) ***In the Shadow of the Levee:*** L3: 3501-B
Communicating Residual Risk. Steven Wolf,
 MCP3, JEO Consulting Group
Communicating Levee-related Flood Risk
with the Risk MAP Playbook. Alex Wendell,
 Resilience Action Partners

A7 ***Tools for Risk Communication*** L3: 3501-C
Moderator: Stephanie Bany Porter, GISP, CFM,
 AECOM
****Engaging Millennials in Flood Risk: Lessons***
Learned from the New North Carolina Flood
Website for Multi-Audience Outreach. John
 Dorman, CFM, North Carolina DPSEM
The Listening Dashboard: EPA Drives Flood
Resilience with Data Analytics. Janice Roper-
 Graham, ABC, PMP, CFM, Outreach Process
 Partners
Communicating Relevant, Actionable, Flood
Protective Actions to the Public.
 Jacqueline Snelling, FEMA HQ

A8 ***AECOM Showcase*** L3: 3501-D
Communicating the Value of the National
Flood Mapping Program.
Moderator: Dr. Gerald E. Galloway, Jr., Glenn L.
 Martin Inst. Professor of Engineering, Dept. of
 Civil & Environ. Eng., Affiliate Professor, School
 of Public Policy, Univ. of Maryland
 AECOM invites you to join us as we explore
 new ways to communicate the value of
 the National Flood Mapping Program in the
 years to come. Credible, modern, nationwide
 flood mapping data is a driver for economic
 growth, security, and protection of our na-
 tion's most-critical assets.

Noon-1:30

Keynote Luncheon BR
Implementing Climate Change on the
Ground: David Reidmiller, PhD, Director,
 National Climate Assessment, U.S. Global
 Change Research Program, Washington, DC
Doug Plasencia, PE, CFM, ASFPM Foundation
 President, Moffatt & Nichol
Moderator: Ceil Strauss, CFM, ASFPM Chair,
 Minnesota DNR

1:15-6:30

TECHNICAL/GUEST TOURS (\$)
Brush Creek Deluge of 1977 (\$45) Bus

1:45-4:30

Boulevard Brewery (\$50) Bus

2:30-5:00

TRAINING WORKSHOPS (\$)
Get CRS Credit for Preserving L3: 3501-G
Natural & Beneficial Functions! CRS Activity
420 (\$45)
Instructors: Rebecca Love, The Baldwin Group;
 Lora Eddy, The Nature Conservancy; Lori Cary-
 Kothera, NOAA; Jeff Stone, GISP, CFM, ASFPM

Presenter Training for the L2: 2504-A
WARD'S Floodplain 3D Model (\$45)
Instructor: Mark Walton, CFM, Michigan
 Stormwater Floodplain Assn.

Ethics for Floodplain Mgrs. L3: 3501-H
& Engineers (\$45)
Instructors: Louie Greenwell, GISP, CFM, PRIME
 AE Group; Jessica Baker, PE, PMP, CFM, Halff
 Associates

1:30-3:30

Natural Floodplain Functions L3: 3501-F
Alliance (NFFA) Meeting

1:45-3:15

CONCURRENT SESSION B**B1****Floodproofing**L2: 2502-A

Moderator: Michelle Staff, CFM, Wisconsin Dept. of Natural Res.

Development & Implementation of Dry Flood Proofing Stored at the Point of Use.

Jeffrey Roushey, PE, CFM, ILC Dover

An "Opening" Argument: The Controversy Over Floodshields & the Protection of Glass Storefronts & Curtain Walls. James Colgate,

AIA, Esq., CFM, Bryan Cave

Preparing a More Resilient NYC: Flood Emergency Plans. Clinton Peterson, CFM, New York City Dept. of Bldgs.

B2

Overcoming Resource Challenges L2: 2502-B for Floodplain Mgmt. Administration

Moderator: Anita Nance, Indiana DNR

****Resources for Rural Communities (Building a Framework for Successful Floodplain Mgmt.).*** Becca Fricke-Croft, CFM, Atkins

Reducing Barriers to CRS Entry: Introducing the Oklahoma CRS Toolkit. Monica Cardin, CCEA, CFM, City of Del City, OK

****The Importance of a Unified State Floodplain Program: Working Together to Build More Robust Local Floodplain Mgmt. Programs Throughout Montana.*** Traci Sears, CFM, Montana DNRC

B3

Changing Climate & Rainfall: L2: 2503-A A Modeling Perspective

Moderator: Jeanne Ruefer, PMP, CFM, ASFPM
Region 9 Director, Tetra Tech

B3 (cont.)

****Climate-modified Hydrology L2: 2503-A***

Tests in Colorado: What if the Next Flood Is Worse? Brian Varrella, PE, CFM, Colorado DOT
Flood Hazard Identification & Risk

Assessment Using Predicted Rainfall: 2016 Missouri Flood Event Case Study. Thomas

Schweitzer, PE, PMP, GISP, CFM, Atkins

An Alternative Temporal Rainfall Distribution for Hydrologic Analysis & Design. Joseph Wilson, PE, PH, Wilson Hydro

B4

Response to Recent Flood L2: 2503-B Disasters

Moderator: David Key, PE, CFM, ESP Assoc.

****Success, Challenges & Lessons Learned from Louisiana & Texas Flooding.*** Lisa Jennings, CFM, FEMA RVI

2015 South Carolina Flood Impacts on Dams.

Sam Crampton, PE, CFM, Dewberry

A Tale of Two Floods. Rob Davis, PE, City of Cedar Rapids, IA

B5

Transforming the Flood Mapping L3: 3501-A Program

Moderator: Michael Grasso, GISP, CFM, CDM Smith

Innovative Initiatives in FEMA's Flood Mapping Program: Planning for the Future.

Rick Sacbibit, PE, FEMA HQ

FEMA's Flood Mapping Program: Enhancements Due to NFIP Reform & TMAC Recommendations. David Bascom, FEMA HQ
New Tools for Obtaining Community Input into the Flood Hazard Identification Process. Ferrin Affleck, PE, CFM, Atkins

B6 **View from the Dry Side: Addressing Levee Deficiencies** L3: 3501-B
Moderator: Rodger Denick, PE, CFM, Stantec
In a Levee Midlife Crisis? A SWIF Success Story. Dan Fricke, PE, LEED AP, CFM, JEO Consulting Group
Who's the Boss? Special District Woes, Land Use Goals, & Leveed Land. Colin Rowan, Multnomah Cnty. Drainage Dist., OR
Lower St. Francis Levee System 11 & 12 Study: An "Outside the Box" Approach to Unlocking Large Systems. Lee Beshoner, PE, CFM, FTN Associates

B7 **Michael Baker International Showcase** L3: 3501-C
The Future of Floodplain Management & Mitigation: A State & Local Perspective
Moderator: Jeff Sparrow, PE, PMP, CFM, Sr. Vice President, Michael Baker Int'l
Panelists: Tim Trautman, PE, CFM, Program Manager, Charlotte-Mecklenburg Storm Water Services; Tom Morey, RS, CFM, NFIP Coordinator, Kansas Dept. of Agriculture; Carey Johnson, CTP Program Manager, State of Kentucky; Mitch Paine, CFM, NFIP Coordinator, Nebraska DNR

B8 **Local Stormwater Project Successes** L3: 3501-D
Moderator: Reuben Cozmyer, PE, CFM, AECOM
Designing & Managing Complex Urban Streamway Projects with Multiple Objectives. Chad Johnson, PE, CFM, Olsson Assoc.

B8 (cont.) **Zone AO Challenges in Oklahoma's Prairie Heartland.** L3: 3501-D
 Janet Meshek, PE, SR/WA, CFM, Meshek & Associates
Watershed-scale Stormwater Improvements with Innovative Funding. Aaron Gwinnup, PE, HR Green

3:15-3:45 **Break, Exhibits, Silent Auction** Exh

3:45-5:15 **8th Annual ASFPF Foundation Student Paper Competition** L3:3501-E
Judges: ASFPF Foundation Trustees
Quantifying the Future Flood Impact & Damages in the Chesapeake Bay Regions Under Sea Level Rise & Marsh Migration. Ali Mohammad Rezaie, PhD Student, Civil Environmental & Infrastructure Engineering, George Mason University; Visiting Scholar, Resources for the Future
The Application of Climate Change Uncertainty Quantification for Urban Flood Risk Mgmt. Maryellen Hearn, Technical University of Dresden, Erasmus Mundus Flood Risk Management Master
After the Flood: Exercising Best Practices in Property Acquisition Programs & Open Space Projects. Ashton Rohmer, Master's, Dept. of City & Regional Planning, University of North Carolina-Chapel Hill, specializing in land use & environmental planning and pursuing certificate in natural hazards resilience

3:45-5:15

CONCURRENT SESSION C**C1****Local Mitigation Success Stories** [L2: 2502-A](#)

Moderator: Timothy Trautman, PE, CFM, ASFPM Mitigation POD Facilitator, Charlotte-Mecklenburg Storm Water Svcs.

Creating Successful Partnerships: Lower Onion Creek Flood Mitigation Buyout Project. Pamela Kearfott, CFM, City of Austin, TX

Kingfisher, OK: Small Town Makes it Big Through Collaboration. Rita Henze, RWA, R/W-NAC, CFM, Meshek & Associates

Locking Down the Right Flood Mitigation Plan. Donald Green, PE, Michael Baker Int'l

C2**Changing Attitudes About Higher Standards** [L2: 2502-B](#)

Moderator: John Squerciati, PE, CFM, Dewberry

Engaging Private Enterprise to Promote Flood Safety. Jennifer Gerbasi, CFM, Terrebonne Parish, LA

The Dollars & "Sense" of Flood Resiliency. Adam Reeder, PE, CFM, CDM Smith
Above and Beyond – 200-year Flood Protection for Sacramento's Future. Remi Mendoza, CFM, City of Sacramento, CA

C3**Advancements in Hydrologic Data & Methods** [L2: 2503-A](#)

Moderator: Mark Forest, PE, CFM, HDR
Forging the Middle Ground Between Regression Equations & Detailed Basin Hydrologic Modeling. Carey Johnson, Kentucky Division of Water

C3 (cont.)**Estimating Peak Flows for Ungaged Streams Using Trail Camera Images.** [L2: 2503-A](#)

Mark Hoskins, CFM, Michael Baker Int'l
Delivering High-quality, Integrated Topographic Data for Flood Modeling. Stephen Aichele, USGS

C4**The Role of Wetlands in Watershed Mgmt.** [L2: 2503-B](#)

Moderator: Eileen Shader, American Rivers
What Floodplain Managers Need to Know About Wetland Condition: NWCA 2011 Finds Relationship Between Hydrological Stress & Wetland Health. Myra Price, EPA
****Assessing Multiple Functions of Missouri's Bottomlands: Laying the Groundwork For Wetland Conservation.*** Frank Nelson, Missouri Dept. of Consv.
****The Iowa Watershed Approach.*** Allen Bonini, Iowa DNR

C5**Improving the Customer Experience with Mapping** [L3: 3501-A](#)

Moderator: Meghan Anderson, GISP, CFM, AECOM
Keeping Customer-centric Aspirations in Technical Processing. Amanda Rabenstine, CFM, Michael Baker Int'l
****The Flood Risk Snapshot: Using Flood Risk Datasets to Personalize Flood Risk.*** Joe Martinenza, PE, Georgia DNR
****Flood Risk Information for the Masses: Estimated Base Flood Elevation Viewer.*** Diane Howe, CFM, FEMA, RVI

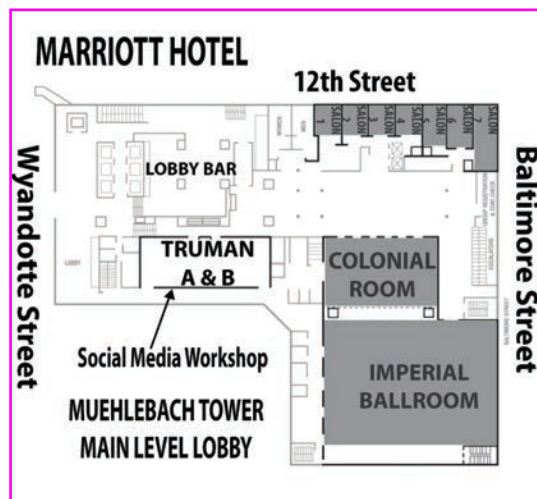
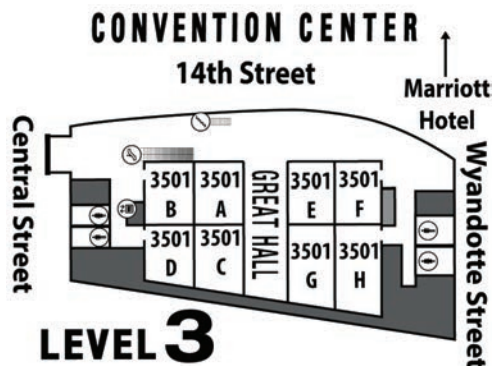
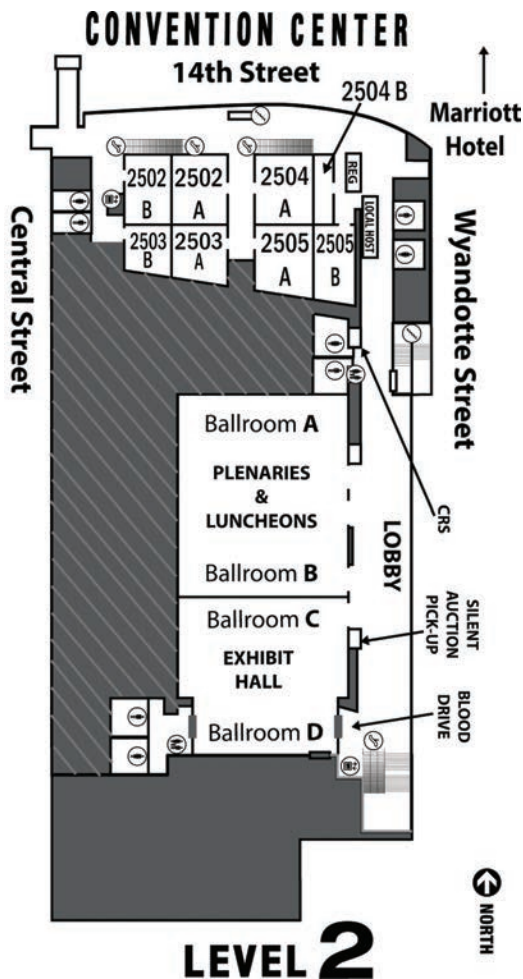

C6 **FEMA Showcase** [L3: 3501-B](#)
Moderator: Eric Letvin, Esq., PE, CFM, Deputy Assoc. Administrator for Mitigation, FEMA's Federal Insurance & Mitigation Admin. (FIMA)
FEMA HMA Grants & Updates. Karen Helbrecht, Acting Director, Hazard Mitigation Assist. Div., Mitigation Directorate
FEMA Floodplain Management Updates. Rachel Sears, Director, Floodplain Management Division, Mitigation Directorate
FEMA Building Science Update. Dan Bass, RA, CFM, Architect, Building Science Branch

C7 **Training & Messaging** [L3: 3501-C](#)
Moderator: Michael Moya, Halff Associates
Supporting Communities, States & Federal Partners – Being a Trusted Advisor to All Levels of Government. Elizabeth Savage, PE, H2O Partners
***A Chapter's Role in Communicating Risk & Training Our Floodplain Managers.** Craig Wenger, AICP, LEED GA, CFM, Michael Baker Int'l
What Did You Say? How to Effectively Convey Technical Concepts to a Non-technical Audience. Necolle Maccherone, CFM, Michael Baker Int'l

C8 **Improving Green Infrastructure Functionality & Acceptance** [L3: 3501-D](#)
Moderator: Jacob Tysz, CFM, ASFPM Region 2 Director, Atkins
Rain to Recreation, A Promise Fulfilled: Regional Watershed Approach to Manage Stormwater. Thomas Jacobs, PE, CFM, City of Lenexa, KS

C8 (cont.) **Building Resilient Communities with Green Infrastructure One Code at a Time.** [L3: 3501-D](#)
 Julia Noordyk, University of Wisconsin
How to Live with Water: A Collaborative Model for Improved Water Mgmt. Jamelyn Austin Trucks, CFM, Atkins

5:15-7:15 **Exhibits Social, Silent Auction** [Exh](#)
 7:15- Dinner on your own – enjoy Kansas City!

6:15-10:00a **5th Annual Running of the Chapters** *Mar: Bus*
Register to run/walk at the local host team booth. Bus leaves from circle in front of the Marriott Hotel promptly at 6:15am; race begins at 7am.

6:45-8:30a **Early Morning coffee break** *Exh*

7:00-3:30 **Exhibit Hall Hours** *Exh*

7:00-5:00 **Registration Desk Hours** *Reg*

7:30-5:00 **Speaker Prep Lounge Hours** *L2: 2505-A*

7:00-8:15 **EARLY BIRD DISCUSSIONS**
Challenges of Agricultural Structures in the Floodplain: Regulations, Insurance and More *L2: 2502-A*

Moderator: Bruce A. Bender, CFM, Flood Insurance Cmte.

Farmers and agribusinesses face unique challenges when it comes to building, maintaining and insuring agricultural structures in the floodplain. A panel of state floodplain officials and FEMA will share their experiences before opening it up for ideas and solutions.

The Documentation of Pre-FIRM Buildings in the Floodplain *L2: 2502-B*

Moderator: Roderick Scott, CFM, Flood Mitigation Specialist. How many pre-FIRM buildings are there in the floodplain? As the NFIP continues to remove the subsidized rates on flood policies, the resale values of these buildings are being negatively impacted. The ASFPM non-structural committee has been asked to move forward with the ASFPM executive team to produce a policy paper on the need to develop an inventory of the pre-FIRM

7:00-8:15

buildings in floodplain areas. Come join us in a discussion to share ideas about how we create this important inventory.

EARLY BIRD DISCUSSIONS (cont.)
Post-flood Mitigation Activities *L2: 2503-A*

Moderator: George Riedel, CFM, Nonstructural Floodproofing Cmte. If you are interested in post-flood mitigation activities that will assist a community recovering from a flood disaster, this session is for you. The session will discuss what steps a community should take to mitigate its exposure to damage from the next flood, how communities in Oklahoma assist each other after a disaster, and what technical assistance the Corps of Engineers can provide to communities after the disaster. Come and join this session to learn new ideas that will help your community after a flood disaster.

Urban Flooding: The Hidden & Growing 21st Century Hazard *L2: 2503-B*

Moderators: Gerald Galloway, PE, PhD, University of Maryland; Jeff Sickles, PE, CFM, Stormwater Mgmt. Cmte. Heavy rainfall events, aging and undersized infrastructure, and development in flood prone areas are dramatically increasing flood losses in urban communities across the country. Urban flooding is significantly impacting the most vulnerable populations. Discuss your experiences with the threat, mitigation measures, and share how to focus greater attention on this neglected challenge.

7:00-8:15

EARLY BIRD DISCUSSIONS (cont.)

Communicating the Value of Natural & Beneficial Functions of Floodplains L3: 3501-A

Moderator: Rebecca Pfeiffer, CFM, Natural and Beneficial Functions Cmte. The use of natural and nature-based approaches in floodplains has increased in recent years, but the value of these approaches need to be effectively communicated to communities and decision makers. This interactive session will be an opportunity to discuss communication approaches that have worked, and additional tools needed to effectively promote natural and nature-based approaches.

2-D Hydraulic Modeling Issues L3: 3501-B

Moderator: David Knipe, PE, CFM, Mapping & Engineering Standards Cmte. The mapping and engineering standards committee is hosting an early bird session on issues with respect to 2-D hydraulic modeling. With the release of HEC-RAS 5.0 and initial guidance from FEMA on incorporating 2-D modeling results into a Flood Insurance Study, there has been more interest in this topic than ever. This session will feature a discussion of critical issues with respect to 2-D modeling, with emphasis on future efforts the committee can take to advance the discussion further.

8:30-10:00

PLENARY SESSION 2

BR

Spotlight on Innovative Mapping and Data Tools *Panel Members:*

1. **David Guignet**, PE, State NFIP Coordinator & Chief of Regulatory Services Division, Wetlands & Waterways Program, Maryland Dept. of the Environment, Baltimore, MD
2. **Dave Canaan**, Water & Land Resources Director, Mecklenburg County Water & Land Resources, Charlotte, NC
3. **Todd Davison**, Program Director, NOAA Office for Coastal Mgmt.
4. **Nicholas Shufro**, Asst. Administrator, Federal Insurance & Mitigation Administration, FEMA/DHS

Moderator: **Larry Larson**, PE, CFM, ASFPM Sr. Policy Advisor, Director Emeritus

10:00-10:30

Break, Exhibits, Silent Auction

Exh

10:00-3:30

Blood Drive: In Memory of Past ASFPM Chair Greg Main, Lobby: Exh
Sign up to donate at the Local Host Booth outside L2: 2505-B.

10:30-Noon

State & Federal Panel Roundtable Discussion BR *(Invitation Only)* Federal officials from several agencies as well as regional staff will be on hand to have an open & forthright dialog on partnership opportunities, programmatic issues, and how states and federal agencies can work together to reduce the nation's flood risk.

10:30-Noon

CONCURRENT SESSION D

D1

Mitigation & Resilience Planning [L2: 2502-A](#)

Moderator: Cindy Popplewell, PE, CFM, Amec Foster Wheeler

Improving Community Resilience Through Integrated Risk Modeling & Community Planning. Mike Robinson, CFM, AECOM
Drought, Fire, & Flood: Connecting the Hazards & Planning for the Triple Threat.

Jeffrey Henson, CFM, JEO Consulting Group
Implementing Socio-ecological Resilience into Floodplain Planning, Design, & Capital Projects. Steve Moddemeyer, CollinsWoerman

D2

Int'l Floodplain Mgmt. Policy [L2: 2502-B](#)

Moderator: Bo Juza, PhD, CFM, ASFP
International Cmte. Co-Chair, DHI

The Economic Argument for Amphibious Retrofit Construction. Elizabeth English, PhD, University of Waterloo

The EU Floods Directive: What We Can Learn from the European Experience. Anna Serra-Llobet, University of California, Berkeley
A Review of Risk-based Approaches in the US & Abroad: Lessons for the NFIP. Mike Seering, PE, CFM, AECOM

D3

Advancements in 2D Modeling [L2: 2503-A](#)

Moderator: Kim Dunn, PE, D.WRE, CFM, Dewberry

Hyper-resolution Flood Assessments in Urban Areas Using 2D GPU Modeling. Reinaldo Garcia, PhD, Hydronia

D3 (cont.)

From Nuisance Flooding To Major Disasters: Analyzing Urban Low Impact Development Techniques with a 2D Flood Routing Model. Noemi Gonzalez Ramirez, PhD, FLO-2D Software
Creative Applications for 2D Rapid Inundation Modeling. Elise Ibendahl, PE, ENV SP, CFM, CH2M

D4

Preparing Local Governments for Disaster Workloads [L2: 2503-B](#)

Moderator: French Wetmore, CFM, French & Associates

Preparing Your Floodplain Administration & Building Department for a Disaster. Manny Perotin, PE, CFM, CDM Smith
Disaster Preparedness for Local Code Officials. Gary Mullinix, CBCO, CFM, SAFEbuilt
Floodplain Mgmt. Post-disaster: How to Handle Activity Demands from Residents, State, & FEMA. Julie Grauer, FEMA HQ

Noon-1:30

Lunch on your own (*concessions on-site*)

12:20-1:30

States Networking Lunch with CRS [BR](#)
NFIP State Coordinators, CRS State Coordinators, CRS User Group Leaders, Community CRS Coordinators, and Floodplain Managers are invited to gather with FEMA, ISO, and the CRS Consultant team for a networking (***bring your own lunch***) discussion.

1:30-3:30

ASFP Chapters Meeting [L3: 3501-G](#)
(*Chapter Board & Committee Leaders*)

1:30-3:00

E1

CONCURRENT SESSION E

Leveraging Funding for Mitigation Projects L2: 2502-A

Moderator: Jen Marcy, CFM, ASFPM Training & Outreach Cmte. Co-Chair, Atkins

***Financing Resilience in Connecticut: Current Programs, National Models, & New Opportunities.** Wayne Cobleigh, CPSM, GZA GeoEnvironmental
Solutions for Capturing Cost Share by Leveraging Multiple Funding Sources to Maximize Recovery Options. Franki Coons, CFM, AFC Partners
Developing Coordinated Funding to Reduce Local Flood Risk. Jonathan Raser, CFM, Tetra Tech

E2A

Flood Insurance in Practice & Theory L2: 2502-B

Moderator: Katie Sommers, CFM, Wisconsin Emerg. Mgmt.

NFIP Changes & Pricing. Phillip Dunn, National Flood Services
Update from FEMA's Office of the Flood Insurance Advocate. Rhonda Montgomery, CFM, FEMA HQ
Is it In or Out? Rethinking the Mandatory Purchase Requirement. Duncan Hastie, PE, Dewberry

E2B

Local CRS Implementation Across the Country L2: 2503-A

Moderator: David Stroud, CFM, Amec Foster Wheeler

Marriage of Dallas, TX CTP & CRS: A Blissful Union. Steve Parker, PE, CFM, City of Dallas, TX

E2B (cont.)

Fort Collins, CO: Be Flood Ready- A CRS Program for Public Information. L2: 2503-A

Marsha Hilmes-Robinson, CFM, Fort Collins, CO

The NFIP's Community Rating System: Bridging Adaptation Gaps in Coastal Communities. Mary-Carson Stiff, JD, CFM, Wetlands Watch

E3

2D Modeling & Mitigation L2: 2503-B

Moderator: Mike Schlesener, GISP, AECOM

Elkhorn River Long-term Bank Stabilization Project. Sara Mechtenberg, PE, FYRA Engineering
SMART Flood Risk Planning Using HEC-RAS 2D. Brinton Swift, PE, CFM, HDR
Urban Floodplain Modeling with HEC-RAS Combined 1D/2D Fargo, ND. Adam Nies, PE, CFM, Houston Engineering

E5

Coastal Impacts of Climate Change L3: 3501-A

Moderator: Brian Caufield, PE, D.CE, CFM, CDM Smith

Storm-induced Coastal Erosion for Flood Insurance Studies & the Missing Link to Forecasting Coastal Flood Damage Impacts: Erosion, Runup, & Overtopping. Jeff Gangai, CFM, Dewberry
Accounting for Long-term Erosion & Sea Level Rise in New England: A TMAC Recommendation. Elena Drei-Horgan, PhD, CFM, AECOM
Looking to the Future - San Francisco Bay Area Increased Flooding Scenarios. Kristen MacDougall, CFM, AECOM

E6 Changing Risk Analysis Methods [L3: 3501-B](#) in a Changing World

Moderator: Gene Barr, CFM, Arcadis

Using Risk Analysis to Inform Levee Investment Priorities in the California & Dutch Deltas. Jessica Ludy, CFM, Environmental Science Assoc.

Climate Change & its Effect on the Resiliency of Our Dams & Levees. Scott Brand, PE, HDR
Application of Risk Informed Decision Making & Potential Failure Mode Analysis to Improve Resiliency of Critical Floodplain Infrastructure. Robert Beduhn, PE, ENV SP, HDR

E7 What's New at FEMA for Outreach [L3: 3501-C](#)

Moderator: Bruce Bender, CFM, ASFPM

Insurance Cmte. Co-Chair, Bender Consulting Svcs.

Enhancing the NFIP: Lessons Learned from FEMA's Customer Experience Initiative.

Priscilla Scruggs, FEMA, FIMA

Customer-centric Approaches for Communicating Map Changes. Priscilla Scruggs, FEMA, FIMA

The Future of FEMA's Coastal Flood Information. Tucker Mahoney, FEMA HQ

E8 Green Infrastructure to Reduce [L3: 3501-D](#) Flood Damage

Moderator: Tim Hillier, PE, CFM, ASFPM Coastal Cmte. Co-Chair, CDM Smith

China's Sponge Cities Initiative, Lessons Learned from the US. Kari Mackenbach, DCES, ENV SP, CFM, ms consultants

E8 (cont.)

**Would You Like to Understand the [L3: 3501-D](#)
Flood Control & Resiliency Benefits of Green Infrastructure?.** Jennifer Walker, PE,

D.WRE, CFM, Watearth

Changing the Paradigm: Stormwater Mgmt. in New Orleans, LA. Jessica Watts, PE, D.WRE, ENV SP, CFM, CDM Smith

E9 States Day: Mitigation [L2: 2504-A](#)

Moderator: George Riedel, CFM, ASFPM

Nonstructural Floodproofing Cmte. Co-Chair, Michael Baker Int'l

***Development & Feasibility of a State Led Flood Audit Program.** Michelle Burnett, CEM, CFM, Rhode Island EMA

***Community Resilience & Historic Resource Preservation: Preserving Quality of Life in Connecticut.** Scott Choquette, CFM, Dewberry

***Silver Jackets – Teaming to Mitigate & Manage State Flood Hazard Priorities.** Ellen Berggren, USACE

3:00-3:30

Break, final Exhibits Viewing, final Silent Auction bids at 3:30pm!

[Exh](#)

3:30-5:00

[CONCURRENT SESSION F](#)

F1 Encouraging Mitigation Action [L2: 2502-A](#)

Moderator: Jeremias Alvarez, PwC

Flood Economics: How Flood Mitigation Investment Returns Positive Benefits.

Kathleen Boyer, FEMA HQ

***Mitigation Actions Through Communication.** George Riedel, CFM, Michael Baker Int'l

Engaging Communities to Reduce Risk: Who, When, How, & Other Lessons Learned. Karen Amrhein, STARR II/ Atkins

F2 CRS: What's New & Local Program Administration L2: 2502-B

Moderator: Brian Varrella, PE, CFM, ASFP
Region 8 Director, Colorado DOT

The CRS Program – Looking at Current Changes & Considering Measures of Effectiveness. Bill Lesser, CFM, FEMA HQ
CRS Cycle Visits Since 2013: Nuances, Triumphs, & Tribulations. Kimberley Pirri, PE, CFM, AECOM
Coordinating CRS Success on a County Scale. Cynthia Addonizio-Bianco, AICP, PP, LEED BD+C, CFM, Tetra Tech

F3 Beyond Flood Modeling: Assessing Other Hazards & Components L2: 2503-A

Moderator: Nathan Slaughter, AICP, CFM, ESP Associates

Mud & Debris Flow Study in Aspen, CO.

Dai Thomas, PhD, Tetra Tech

Simulating Surface Runoff & Sediment Transport Using CHRE2D Model. Jennifer Duan, University of Arizona

Connecting Mapped Risk to Actual Risk to What's at Risk. David Skuodas, PE, LEED, AP, CFM, Urban Drainage & Flood Ctrl. Dist.

F4 Watershed-level River Planning & Management L2: 2503-B

Moderator: Claire Jubb, AICP, CFM, Charlotte Cnty., FL

One Watershed, One Plan: A Case Study of Integrated Watershed Planning for Multiple Benefits. Shawn Tracy, HR Green
Souris River, ND: Collaborative Flood Risk Mitigation Success Story. Terry Zien, PE, CFM, USACE

F4 (cont.) The Yellow River Initiative & the Restoration of the Kankakee River Basin. L2: 2503-B

Robert Barr, Indiana University - Purdue

F5 Modeling to Mapping to Warning L3: 3501-A

Moderator: Doug Marcy, NOAA

Rapid, Dynamic, & Real-Time Flood Inundation Mapping for Emergency Mgmt. (& Planning). Sean McFeely, Riverside Technology
Rapid Flood Mapping Using Inundation Libraries. Jude Kastens, University of Kansas

The Water Is Rising – Scalable, Reliable, & Relevant Flood Warning & Forecasting Supporting First Responders. Jim Keith, PE, CFM, Walter P. Moore & Assoc.

F6 Levee Risk Modeling L3: 3501-B

Moderator: John Brubaker, PE, CFM, North Carolina DPS

Web-based Automated, 2D Levee-Failure Flood Simulation using DSS-WISE™ Lite. Mustafa Altinakar, PhD, University of Mississippi

Levee Performance & Floodplain Risk Analysis with HEC-WAT. Lea Adams, PE, USACE

Planning for Levee Breach in Dubuque, IA: Modeling & Development of Mitigation Strategies. Andy McCoy, HDR

- F7** **Tools for Risk Communication** L3: 3501-C
& Floodplain Management
Moderator: CeCe McKiernan, CFM, Florida Floodplain Mgrs. Assn.
Crowdsourcing Mobile Apps in Floodplain Management. Gopal Raja, Ideation, Inc.
Texas CHARM Engages Stakeholders: A Texas A&M and FEMA CTP Tool for Risk Communication. Steven Mikulencak, AICP, Texas A&M University
Federal Partnered Collaborations Helping to Build a Weather Ready Nation. Victor Hom, NOAA, NWS
- F8** **Stormwater Mgmt. Policy** L3: 3501-D
Moderator: John Gysling, PE, CFM, ASFPM Region 3 Director, New Castle Cnty., DE
Stormwater Mgmt.- NAI, the State of the Art. Ron Flanagan, CFM, Flanagan & Assoc.
How Has Federal Stormwater Program Evolved & What Does it Mean for You? Todd Williams, Michael Baker Int'l
Approaches for Determining & Complying with TMDL Requirements Related to Stormwater Runoff. Anna Lantin, Michael Baker Int'l
- F9** **State Chapter Action,** L2: 2504-A
Floodplain Regulations, Disaster Recovery
Moderator: Brock Remus, CFM, Atkins
***Building an Effective Legislative Education Program to Support Flood Risk Reduction.** Tom Leatherbee, AINS, MCP, CFM, Oklahoma Floodplain Mgrs. Assn.

- F9 (cont.)** ***Improving the Compliance of** L2: 2504-A
Manufactured Homes Installed in Floodplains. Suzanne Sarpong, Arizona DWR
***When Disaster Strikes... Again: Response & Recovery in South Carolina.** Maria Cox Lamm, CFM, South Carolina DNR
- 5:15-6:45 **FEMA Town Hall Session** BR
Featuring panelists from FEMA
The Federal Emergency Management Agency (FEMA), through its Federal Insurance & Mitigation Administration (FIMA), manages the National Flood Insurance Program (NFIP) and a range of programs designed to reduce loss of life and property from natural disasters. The executive leadership from FIMA will host an interactive forum to engage the ASFPM audience on how we might collectively build a path towards significantly increased flood insurance coverage and mitigation investments in the long-term. All attendees are encouraged to visit the FEMA exhibit booths on Monday and Tuesday to submit their creative strategies and learn more about how to participate in this year's session.
- 6:45-8:00 **Foundation Donors Appreciation Reception & LIVE Auction** *(Invitation Only)*
If you did not receive an invitation as a Foundation donor since July 2016, you can still buy your way in with a \$100 donation! Just visit the Registration Desk.
- 6:45.... Dinner on your own, enjoy Kansas City!

6:45-8:30 **Early morning coffee break** *Lobby: BR*

7:00-5:00 **Registration Desk Hours** *Reg*

7:30-5:00 **Speaker Prep Lounge Hours** *L2: 2505-A*

8:00-5:00 **Silent Auction Pickup** *L2: 2526-A*

7:00-8:15 **REGIONAL DISCUSSION SESSIONS**

Region 1 *L2: 2502-A*

Region 2 *L2: 2502-B*

Region 3 *L2: 2503-A*

Region 4 *L2: 2503-B*

Region 5 *L2: 2504-A*

Region 6 *L3: 3501-A*

Region 7 *L3: 3501-B*

Region 8 *L3: 3501-C*

Region 9 *L3: 3501-D*

Region 10 *L3: 3501-E*

8:30-10:00 **PLENARY SESSION 3** *BR*

Nonstructural Mitigation: Success Stories from the Front Lines!

1. Partnering for Flood Risk Reduction

Since the '90s: David Sturch, Code Enforcement Manager, Cedar Falls, IA

2. Local Investment in Mitigation Builds

Community Resilience: Stan Polivick, Assistant Public Works Director, City of Cape Girardeau, MO

3. Packaging Programs to Mitigate

Effectively: Tony Mercantante, PP, AICP, Twp. Administrator, Middletown, NJ

Moderator: Maria Cox Lamm, CFM, ASFPM Vice Chair, South Carolina DNR

10:00-10:30 **Break** *Lobby: BR*

10:30-Noon

CONCURRENT SESSION G

G1

Mitigation Project Process Guidance *L2: 2502-A*

Moderator: Robert Freitag, CFM, ASFPM Higher Educ. Cmte. Co-Chair, University of Washington

Elevation Project Outreach Education Tool Kit for Property Owners. Roderick Scott, CFM, L & R Resources

Best Practices in Home Elevation. Tammie DeVooght Blaney, Int'l Assn. of Structural Movers

****Transfer of Development Rights for Tax-base Neutral Flood Risk Management.*** Lisa Hollingsworth-Segedy, AICP, American Rivers

G2

Research in Floodplain Mgmt. *L2: 2502-B*

Moderator: Kenneth Ashe PE, PMP, CFM, Amec Foster Wheeler

****Who Lives in Floodplains? A Demographic Study in Nebraska.*** Mitch Paine, CFM, Nebraska DNR

Influence of Road Characteristics on Vehicle-related Flood Fatalities. Andrew Gissing, Macquarie University, Risk Frontiers

Creating a Water Risk Index to Improve Community Resilience. Lobna El Gammal, Carnegie Mellon University

G3

Automated Modeling to Identify Risk *L2: 2503-A*

Moderator: Victor Hom, NOAA, NWS
2D Large Scale Automated Engineering for FEMA Floodplain Development in South Dakota. Eli Gruber, PE, CDM Smith

G3 (cont.) **Out with the Old, In with the New:** [L2: 2503-A](#)
Implementing the Results of the Iowa Rapid Floodplain Modeling Project. Traci Tylski, CFM, USACE, Omaha Dist.
South Dakota LSAE: How FEMA & its Stakeholders Benefit from 2D LSAE. Brandon Banks, GISP, AECOM

G4 **Response to Recent Flood Disasters II** [L2: 2503-B](#)
Moderator: Dean Goodison, PE, CFM, Atkins
Come Hell or High Water: The LFMA DRT Response to the Great Flood of 2016. Shandy Heil, CFM, Louisiana Floodplain Mgmt. Assn.
Louisiana Underwater: Resiliency Hangs in the Balance. Shona Gibson, FEMA RVI
History & Significance of Coastal Federal Disaster Declarations from 1953-2016. Darryl Hatheway, CFM, AECOM

G5 **Coastal Interactions** [L3: 3501-A](#)
Moderator: Maureen O'Shea, AICP, CFM, Idaho DWR
King Tides: How this Event has Risen into Our Vocabulary. Brian Caufield, PE, D.CE, CFM, CDM Smith
Prioritizing Re-mapping & Analyses of Rivermouths in Coastal Areas Following FEMA Region IX's Coastal Re-study. Vince Geronimo, PE, CFM, AECOM
***NC Flood Warning System: Ground Truth Comparisons During Hurricane Matthew.** Dan Brubaker, PE, CFM, North Carolina DPSEM

G6 **USACE & FEMA Working Together** [L3: 3501-B](#)
with Your Help to Address the Nation's Levee Challenges
Moderator: Samantha Medlock, Willis Towers Watson
Panelists: Suzanne Vermeer, PE, CFM, FEMA HQ, Steven Fink, PE, USACE, Jim Murphy, PE, CFM, AECOM

G7 **Best Practices in Floodplain Mgmt.** [L3: 3501-C](#)
Moderator: Corey Garyotis, PE, CFM, Alabama DECA
Managing Change in a Time of Transition: Tools & Best Practices for Floodplain Mgrs. Katrina Tavanlar, Booz Allen Hamilton
Record Keeping for the Floodplain Administrator. Steve Samuelson, CFM, Kansas Dept. Agriculture
Generating Data, Risk Awareness & Tools for Local Benefit: Base Level Engineering. Elizabeth Savage, PE, H2O Partners

G8 **Local Stormwater Initiatives** [L3: 3501-D](#)
Moderator: Stephen Noe, PE, Amec Foster Wheeler
Ladue, MO's Stormwater Mgmt. Program. Josiah Holst, PE, CFM, HR Green
A One Water Framework: Integrating Floodplain & Stormwater Mgmt. Requirements for Communities. Sara O'Brien, Williamette Partnership
Evaluation of a Successful Watershed Partnership: 15 Years Later. Amanda Grint, PE, CFM, Papio Missouri River NRD, NE

Noon-1:45 **ASFPM National Awards Luncheon** *BR*
Sponsored by: PWC
and invitation to the ASFPM 2018
 Conference in Phoenix, June 17-22, 2018,
 hosted by the Arizona Floodplain Management
 Association.

1:15-5:00 **TECHNICAL/GUEST TOUR (\$)**
Big Muddy River (\$45) *Bus*

2:30-5:00 **TRAINING WORKSHOPS (\$)**
*** Avoiding Litigation & Lessons Learned (\$45)** *L2: 2504-A*
Instructor: T. Lynn Lovell, PE, D.WRE, CFM, Halff Associates

Balancing Flood Protection & Floodplain Restoration (\$45) *L3: 3501-G*
Instructor: Michael Vecchio, HDR

Prop Up Training with Props (\$45) *L3: 3501-H*
Instructor: Steve Samuelson, Kansas Dept. Agriculture

2:00-3:30 **CONCURRENT SESSION H**
H1 Building Resilience into Critical Facilities & Businesses *L2: 2502-A*
Moderator: Rob Flaner, CFM, Tetra Tech
Emergency Power Systems for Critical Facilities: A Best Practices Approach.
Gregory Wilson, FEMA HQ
A Flood Vulnerability Assessment for Critical Facilities. *Lisa Graff, CFM, Illinois State Water Survey*

H1 (cont.) Small- & Mid-size Business Disaster Preparedness & Resilience in New Orleans, LA. *L2: 2502-A*
Taylor Daigle, AECOM

H2 Local Successes with Higher Floodplain Management Standards *L2: 2502-B*
Moderator: Rebecca Fricke-Croft, CFM, Atkins
A Collaborative Approach to Reduce Local Flood Insurance Rates in Coastal Georgia.
Madeleine Russell, CFM, Georgia Sea Grant
Raising the Bar: Adoption of Enhanced Elevation Requirements in New Orleans, LA.
Jared Munster, PhD, AICP, CFM, City of New Orleans, LA
Maximizing Your Floodplain Mgmt. Ordinance for Risk Reduction. *James Holley, AICP, CFM, City of Blue Springs, MO*

H3 Managing Data for Better Modeling *L2: 2503-A*
Moderator: Michael Cothard, PE, CFM, Christopher B. Burke Eng.
Flood Study Needs Assessment, Process, & Tools for Bulk Geoprocessing of Large Datasets. *William Jiang, PE, CFM, AECOM*
Papillion Creek Watershed: Making the Most of Available Data. *Lori Laster, CFM, Papio Missouri River NRD, NE*
Flood Modelling - 9 Ways to Reduce the Cost of Flood Modelling. *Phillip Blonn, PE, CFM, CH2M*

H4

Restoration Projects [L2: 2503-B](#)
Moderator: Jessica Lay, Olsson Associates
Building a Floodplain Restoration Movement.
 Eileen Shader, CFM, American Rivers
Case Study: Bank Stabilization, Flood Reduction & Water Quality Improvement Design Build Project. Ajay Jain, PE, CFM, HR Green
The Largest Wildlife Refuge Restoration Project in the Eastern US. Sravan Krovidi, PE, CFM, Amec Foster Wheeler

H5

Communicating Flood Risk [L3: 3501-A](#)
Moderator: Emily Whitehead, GISP, CFM, Stantec
Fill, Floodways & BFEs: The Unsteady State of Floodplain Mgmt. Del Schwalls, PE, CFM, Schwalls Consulting
Communicating Flood Risk with a Story Map. Taunnie Boothby, CFM, Matanuska-Susitna Borough, AK
Be Flood SAF(ER): Situational Awareness for Emergency Response – A River Flooding Extent Map Viewer. Jared Allen, NOAA, NWS

H6

Complex Flood Control Projects [L3: 3501-B](#)
Moderator: Edward Beadenkopf, PE, CFM, Atkins
Determining Residual Flood Risk Associated with a Complex Levee System Fort Bend County, TX. Jonathan Simm, PhD, C.Eng., Bsc, HR Wallingford
The FM Area Diversion Project: Protecting Fargo-Moorhead, ND from Catastrophic Flooding. Eric Dodds, AE2S

H6 (cont.)

The Bottoms: A 2D Analysis of Trinity River Levee Interior Drainage System. Sirak Bahta, PE, CFM, City of Dallas, TX

H7

Tools to Inform Decision Making [L3: 3501-C](#)
Moderator: Greg Williams, CFM, Delaware DNREC
Complex Levee System Fort Bend County, TX. Brian Batten, PhD, CFM, Dewberry
Empowering Communities: New Technologies to Engage on Flooding Rains. Raymond Laine, PhD, Ozengage
2017 Coastal Master Plan Data Viewer. Andrea Galinski, ASLA, CFM, Louisiana Coastal Protection & Restor. Auth.

H8

Gray + Green Infrastructure = Better Projects [L3: 3501-D](#)
Moderator: Chip Hague, CFM, Charlotte Cnty., FL
Advanced Sustainable Urban Stormwater Infrastructure. Mark Joersz, Advanced Drainage Systems
Kenilworth, IL Green Streets: Combining Porous Asphalt & Permeable Parkways to Reduce Flooding in a Combined Sewer Area. Joy Corona, PE, CFM, Bleck Engineering Co.
Integrating Green & Grey Public Infrastructure within a Framework of Multiple Ownership. Laura Mwirigi Rightler, PE, CFM, Civil Design

3:30-4:00

Break

[Lobby: BR](#)

4:00-5:30

J1

CONCURRENT SESSION J

FEMA Mitigation Policies & Requirement [L2: 2502-A](#)

Moderator: Janet Thigpen, CFM, ASFPM District 1 Chapter Director, STC Reg'l Planning Bd.

Averting a Second Disaster: Leading Financial Oversight Practices Following Disasters.

Michael Herman, Ernst & Young

FEMA's Support for Hazard Mitigation & Resiliency: Preparing for the Impacts of Climate Change. Jordan Williams, CFM, CDM Smith

Mitigation Benefits Estimator: Automating the FEMA BCA Toolkit for Structure-based Project Prioritization. Paul Vidal, Stantec

J2

Local & Coastal Flood Loss Reduction Initiatives [L2: 2502-B](#)

Moderator: William Nechamen, CFM, ASFPM Regulations Cmte. Co-Chair, New York State DEC

US Military Sites on the Frontlines of Rising Seas. Shana Udvardy, CFM, The Union of Concerned Scientists

Flood Smart Communities: Municipalities Working Together To Build Flood Resilience. Jayme Thomann, AICP, CFM, Genesee/Finger Lakes Regional Planning Council

Strategies for Smart Growth & Long-term Flood Risk Reduction: Tipton, IN Case Study. Sheila McKinley, AICP, CFM, Christopher Burke Eng.

J3

2D Modeling Solutions for Unique Conditions [L2: 2503-A](#)

Moderator: Rocky Keehn, PE, D. WRE, ENVSP, LEED AP, CFM, Common Sense WRE

Overland Flow Modeling Through Joliet, IL Using HEC-RAS 2D. Aaron Thomas, CFM, Illinois State Water Survey

2D Modeling for a 1D LOMR in a 3D World: Three "Simple" Stories. Rachel Pichelmann, PE, CFM, SHE

HEC-RAS Hydraulic Modeling Methods of Densely Populated Areas. Jesse Pope, CFM, Gannett Fleming

J4

Nature-based Flood Reduction II [L2: 2503-B](#)

Moderator: Brian Killen, CFM, Stantec

****Innovative & Emerging State Policies & Programs Incentivizing Nature-based Solutions for Erosion, Risk Reduction & Environmental Benefits.*** Sarah Murdock, The Nature Conservancy

Mapping Floodplains, Populations At Risk, & Opportunities for Nature-based Risk Reduction for the Continental US. Kris Johnson, PhD, The Nature Conservancy
Nature-based Floodplain Mgmt. Exists & Federal Agencies Should Know How to Implement It. Jonathon Loos, American Rivers

J5

Partnerships for Mapping & Modeling Success [L3: 3501-A](#)

Moderator: Chris Budd, CFM, Atkins

A Modern CTP Program Vision: Our Operational Approach for the Next Five Years. Laura Algeo, PE, FEMA HQ

J5 (cont.)

***Value of Local Partnerships:** L3: 3501-A
Texas Water Development Board CTP Program. Cindy Engelhardt, CFM, Halff Associates
Risk MAP - Use the Data You Already Have for a Better Result! Claire Jubb, AICP, CFM, Charlotte Cnty. Bd. of Cmsnrs.

J6

Levees in Region VII: Mapping, Mgmt., & Insurance L3: 3501-B
Moderator: Sally Cook, CFM, Manatee Cnty., FL
FEMA RVII Levee Mapping Strategy. Rick Nusz, PH, PHG, CFM, FEMA RVII
What's Your Story? FEMA RVII Levee Data Documentation for the Future to Share Our Past. William Zung, PMP, CFM, Stantec
***Communicating Full Risk Insurance Rates in the Heartland.** Louie Greenwell, GISP, CFM, PRIME AE Group

J7

Case Studies in Risk Communication L3: 3501-C
Moderator: Stephanie Routh, HzP, CFM, Dewberry
Interagency Collaboration & Decision Support Services in the 2015 Meramec River Record Flood. Jonathon Thornburg, NOAA, NWS
New Technology Helps Citizens & Community Officials Before, During & After Flood Events. Susan Beth Wilhelm, EI, CFM, Oklahoma WRB
Communication Challenges During the Historic December 2015 Floods in Missouri. Megan Terry, CFM, NOAA, NWS

J8

Stormwater Modeling to Enable Better Local Decisions L3: 3501-D
Moderator: Bill Brown, PE, Flood Science Ctr. Director, ASFPM
Programs, Projects & Policies Creating Resiliency in Phoenix, AZ. Valerie Swick, CFM, Flood Ctrl. Dist. of Maricopa Cnty., AZ
Community Benefits of Defining an Urban Overland Flowpath. Glen Taffinder, PE, CFM, City of Austin, TX
Evaluating Release Rates for Specific Watersheds in Cook County, IL. Amanda Flegel, PE, CFM, Illinois State Water Survey

6:30-10:00

NETWORKING RECEPTION Off-site
Sponsored by: The Pew Charitable Trusts
 No Other Pub by Sporting KC is a one-of-a kind sports bar, gaming parlor, and social lounge located walking distance from the Marriott in downtown Kansas City's Power & Light District. Enjoy bowling, golf simulators, table tennis, shuffleboard, billiards, foosball, darts, arcade games, and more in the gaming parlor. A shuttle will be available for those with limited mobility. Pre-registration is required. Heavy hors d'oeuvres, desserts, beverages and game play are included. **ATTENDEE/GUEST NAME BADGE OR TICKET MUST BE PRESENTED FOR ADMISSION.**

7:30-Noon	Registration Desk Hours	<u>Reg</u>
	<u>TRAINING WORKSHOPS (\$)</u>	
8:00-Noon	* Effective Hazard Mitigation Planning: A Practical Approach (\$45)	<u>L2: 2503-A</u>
	<i>Instructors:</i> Laurie Bestgen, Jeff Brislawn, Amec Foster Wheeler	
8:00-Noon	Using CHARM to Engage the Public in Community Flood Planning & Management (\$45)	<u>L2: 2503-B</u>
	<i>Instructors:</i> Jeff Stone, GISP, CFM, ASFPM; Steven Mikulencak, AICP, Texas A&M University	
9:00-Noon	CFM Exam	<u>L2: 2504-A</u>

WE BID YOU SAFE TRAVELS HOME

SEE YOU IN PHOENIX!
JUNE 19-22, 2018

ASFPM

ANNUAL CONFERENCE



PHOENIX, AZ
June 17-22, 2018

Managing Floods Where
Mountains Meet the Desert