

ASSOCIATION OF STATE FLOODPLAIN MANAGERS

2019 POCKET GUIDE



ASFPM 2019 Conference Team May 19-23, 2019, Cleveland

Program Chair

Steve McMaster, CFM, Ideation, Inc.

Conference Team

Sarah Waller, Conference & Event Planner
Kevin Currie, Training Coordinator
Suzanne Gillingham, Accountant
Anita Larson, Certification Coordinator & Registration
Michele Mihalovich, Public Information Officer
Jason Scheeberger, IT Manager
Ingrid Wadsworth, CFM, Deputy Director

ASFPM Staff

Chad Berginnis, CFM, Executive Director
Larry Larson, PE, CFM, Sr. Policy Advisor
Gigi Trebatoski, Chapter & Foundation Coordinator
Jim Dunham, Member Services
Nancy Dunham, Certification Assistant
Kami Valenzuela-Sanchez, Certification Assistant
Jennifer Niles, Web Developer

ASFPM Flood Science Center

Drew Whitehair, CFM, Center Director
Bill Brown, PE, Program Manager
Haley Briel, Research Scientist
Melissa Haig, MLS, Research Librarian
Jason Hochschild, GIS & Research Analyst
Alan Luloff, PE, CFM, Chief Scientist
Jeff Stone, GISP, CFM, Senior Project Manager
Dave Fowler, CFM, Project Manager
Beth Klusinske, Research Specialist

Table of Contents

i.....	Conference Team
1.....	Table of Contents
2.....	Welcome and General Information

Conference Sponsors

4.....	Our Sponsors
--------	--------------

The Conference Program

17.....	Sunday
19.....	Monday
23.....	Tuesday
38.....	Wednesday
52.....	Thursday
Center Spread.....	Floor Plan

\$ Indicates a fee-based workshop or tour offered a la carte.

Local Host Team

Alicia Silverio, CFM, Co-chair
Shawn Arden, PE, CFM, Co-chair

Additional Team Members: Mark Seidemann, PE, GISP, CFM; Julie Lawson, PE, CFM; Jim Decker, PE, CFM; Kari Mackenbach, CFM; Jerry Brems, CFM; Chris Rybak, PE, CFM; Chad Boyer, PE, CFM; Duane Matlack, CBO, CFM; George Hadden, PE, PS, CFM; Catrina Covino, CFM; Jason Farrell, CFM; Katherine Goepfner, CFM; Todd Richard, CFM; Matt Whitehead

WELCOME!

Welcome to the 43rd annual conference of the Association of State Floodplain Managers. We are glad that you could join us in Cleveland. This pocket guide will help you get the most out of your week so be sure to keep it close at hand. **Your name badge is your admission and must be worn all week.** If you have questions, see ASFP staff at the registration desk or ask one of the local host volunteers – they will be wearing volunteer shirts while on duty. Please enjoy your week as you dive into the most comprehensive floodplain management training & networking opportunity in the country!

Registration Desk

Exhibit Level

The registration desk is located on the Exhibit Level of the Huntington Convention Center outside Exhibit Hall C. It will be open to serve you 10-5:30 Sunday, 7-5 Monday-Thursday.

Speaker Prep Lounge

2

Conference Program Coordinator Steve McMaster, AV Coordinator Jason Schneeberger and their volunteers will be available to assist you with program and AV concerns throughout the week. Speakers may practice their presentations here and get them queued up for their session. The Speaker Prep Lounge will be open 7:30 am to 5:00 pm, Monday through Thursday.

Local Host / Volunteer HQ

Exhibit Level

The local host team, consisting of OFMA members and floodplain managers from throughout Ohio will take residence near registration. This is also where you can purchase your memorabilia and sign up for the 5K race.

First Timers Orientation will be held Sunday at 3:00pm and 5:00pm, Monday at 10:00am and 3:00pm and Tuesday at 10:00am. New attendees should plan to attend one of these 15-minute sessions to help you get the most out of the week. Meets near registration desk.

Meeting Room Assignments

Most conference activities will take place at the Huntington Convention Center of Cleveland. The location of each session is listed to the right of the event name.

Technical Tour Departure Point

Bus

Bus loading area is located in front of the Huntington Convention Center main entrance on Lakeside Avenue.

Our Sponsors

Creating Resiliency and Sustainability for a Changing World

Water Resources
Community Planning
Geospatial and LiDAR
Program Management
Hazard Mitigation
Transportation Services
Architecture

Michael Baker
INTERNATIONAL

We Make a Difference



moffatt & nichol

Creative People. Practical Solutions.®

Speakers:

Jeff Crump
Session D3, Wednesday
10:30 a.m.

Mike Robinson
Session G3, Thursday
10:30 a.m.

Allison Bryan
Session H5, Thursday
2:00 p.m.

Visit Booth 600/602 to enter your business card for the M&N raffle!

4

Our Sponsors

 Flood Cloud

JACOBS

Leaders in the development and
implementation of fully integrated water
resources solutions

Find out more about Jacobs on booth 511/513

jacobs.com/what-if



125
ANNIVERSARY

Stormwater Management
Flood Risk and Mitigation
Stream Restoration and Stabilization

FREESE & NICHOLS
www.freese.com

5

Our Sponsors



A nationally ranked firm with a community-based practice



www.dewberry.com



SMARTER SOLUTIONS

Engineers. Architects. Scientists. Planners. Surveyors.

Serving Texas, Oklahoma, Louisiana, Arkansas, and now, Florida.



MEMBER OF COMPASS PTS JV

Our Sponsors



**Leading
with Science®**

Our unique capabilities in disaster preparedness, disaster response, and flood infrastructure design establish Tetra Tech as a unique provider of emergency management and community resilience services.



tetratech.com



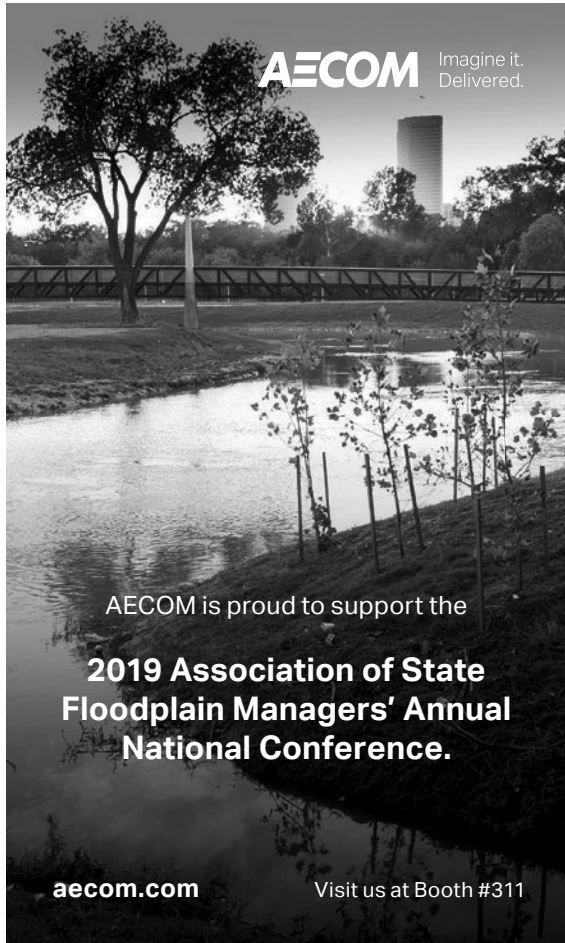

AECOM Imagine it.
Delivered.

AECOM is proud to support the
**2019 Association of State
Floodplain Managers' Annual
National Conference.**

aecom.com Visit us at Booth #311

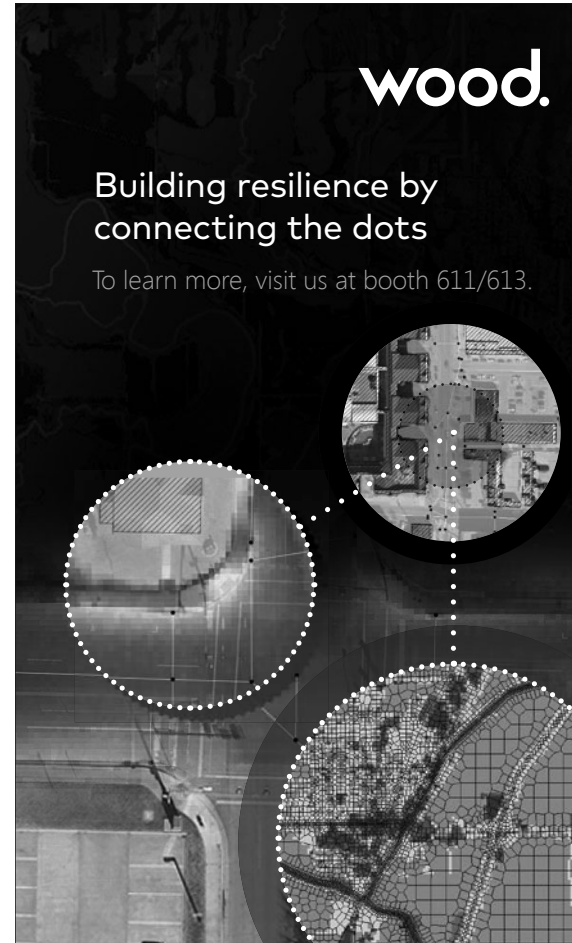

wood.

**Building resilience by
connecting the dots**

To learn more, visit us at booth 611/613.



APPROVED

Mark of Excellence

www.fmaprovals.com



Celebrating Success

because of your
generous donations!

**Be sure to visit the ASFPM Foundation booth at the
front of the Exhibit Hall and meet our special guests:**

- Meet Jesus Mulgado, our first Future Leaders Scholar, and learn about his academic journey to become a future FPM leader
- Learn about the Rocky Mountain Environmental Challenge and meet one of the winning team members from Estes Park Middle School
- Speak with Student Paper Competition semi-finalists about their entries



2017 finalists

**Place your bid at the Foundation
Silent Auction where all proceeds will help
fund the Future Leaders Scholarship.**

Donations gratefully accepted:
www.asfpmfoundation.org/give-now

Our Sponsors

Titanium



FEMA

Our Sponsors

Platinum



ATKINS



Our Sponsors

Gold



Guidehouse

wood.



Dewberry®



ideation

**CDM
Smith**



moffatt & nichol

JACOBS®

ch2m.



THE
PEW
CHARITABLE TRUSTS

IBM®

Our Sponsors

Silver



Our Sponsors

Bronze

Booz | Allen | Hamilton



Nickel



DKCarlton & Associates
Floodplain Management



Sunday, May 19

Sunday, May 19

10:00-5:30	Registration Desk Hours	<u>Reg</u>
7:00-8:00	ASFP Board Member Breakfast (Invitation Only)	<u>26 B</u>
8:00-12:30	ASFP Board Meeting	<u>26 A</u>
12:30-2:00	ASFP Board & Committee Co-Chairs Luncheon (Invitation Only)	<u>26 B</u>
2:00-5:30	ASFP Committee Chairs Mtg. (Invitation Only)	<u>26 A</u>
9:00-5:00	TRAINING WORKSHOP (\$) Floodplain Mgmt. 101 (\$80)	<u>13</u>
	<i>Instructors: Jennifer Marcy, CFM, Atkins; Heidi M. Carlin, CFM, AECOM; and Shanna Michael, CFM, Atkins</i>	
1:00-	TRAINING WORKSHOPS (\$)	
1:00-3:00	The Flood Risk Communication Toolkit for Community Officials (\$45)	<u>11</u>
	<i>Instructors: Priscilla Scruggs, FEMA and Michelle Madeley, FEMA</i>	
1:00-5:00	Reducing Flood Risk Through Nonstructural Floodproofing (\$45)	<u>12</u>
	<i>Instructors: Lea Adams, PE, USACE; John Ingargiola, FEMA; French Wetmore, CFM, French & Associates, Ltd.; and Gene Barr, CFM, Arcadis U.S. Inc.</i>	

1:00-5:00	Cooperating Technical Partners Boot Camp-Improving Resilience (\$45) <i>Instructors: Laura Algeo, PE, FEMA; Necolle Maccherone, CFM, Michael Baker International; and Marc Pearson, GISP, CFM, Stantec</i>	<u>14</u>
3:00-3:15	First Timers Orientation	<u>Reg</u>
5:00-5:15	First Timers Orientation	<u>Reg</u>
5:30-7:00	State Floodplain Mgrs./Hazard Mitigation Officers, & ASFPM Board Directors Meet & Greet <i>(Invitation Only)</i>	<u>Hilton</u>
7:00-10:00	<u>Global Center for Health Innovation Atrium and Ballroom (connected to Convention Center)</u> Welcome Fest Hosted by: OFMA and Local / Chapter Sponsors. For those about to rock! Start off the conference by reconnecting with friends at the Welcome Fest. Live music, food and beverages will be provided. Wear your favorite concert t-shirt for a chance at prizes. ATTENDEE & GUEST NAME BADGES MUST BE PRESENTED FOR ADMISSION.	

Day 1: Monday, May 20

7:00-5:00	Registration Desk Hours	<u>Reg</u>
7:30-5:00	Speaker Prep Lounge Hours	<u>2</u>
8:00-	<u>TRAINING WORKSHOPS (\$)</u>	
8:00-Noon	Hands-On HEC-RAS 2D Workshop (\$45) <i>Instructors: Garret Johnston, PE, GISP, CFM, Freese and Nichols and Jeremy Dixon, PE, CFM, Freese and Nichols</i>	<u>12</u>
8:00-Noon	Watershed Modeling with the USACE ERDC GSSHA and WMS Models (\$45) <i>Instructor: Charles Downer, PhD, PE, PMP, USACE, ERDC</i>	<u>11</u>
8:00-Noon	Flood Insurance for Floodplain Managers (\$45) <i>Instructor: Bruce Bender, CFM, Bender Consulting Services</i>	<u>10</u>
8:00-Noon	How Mitigation Reduces Insurance Rates & Improves Resiliency (\$45) <i>Instructors: Becca Fricke-Croft, CFM, Atkins and Janet Thigpen, CFM, Southern Tier Central Regional Planning and Development Board</i>	<u>13</u>

National Policy Discussions and Regional Discussion Sessions are included in your registration. Complete descriptions can be found on the online program.

8:00-9:00	<u>NATIONAL POLICY DISCUSSIONS</u> General Policy Issues Overview & Legislative Update	<u>25 AB</u>
9:00-9:30	BREAK	<u>Exhibit Level</u>
9:30-11:45	<u>NATIONAL POLICY DISCUSSIONS</u> International Policy 14 Floodplain Regulations.....15 Map. & Eng. Standards19 Mitigation20 Professional Development.....21 Risk Communication & Outreach22	
10:00-10:15	First Timers Orientation	<u>Reg</u>
Noon-1:00	Lunch on your own (on-site concessions will be available near registration)	
Noon-1:00	<u>REGIONAL DISCUSSION SESSIONS</u> Hosted by your elected Regional Directors (organized by FEMA regions). Region 1..... 14 Region 2.....15 Region 3.....19 Region 4.....20 Region 5.....21 Region 6.....22 Region 7.....23 Region 8.....24 Region 9.....25 Region 1026A	

1:00-5:00	<u>TECHNICAL TOUR (S)</u> The Hazard Mitigation & Resilience Tour (\$45)	<u>Bus</u>
1:00-	<u>TRAINING WORKSHOPS (S)</u>	
1:00-3:00	FEMA P-348, Protecting Building Utility Systems from Floods (\$45) <i>Instructors: Daniel Bass, RA, CFM, FEMA and John Squerciat, PE, CFM, STARR/Dewberry</i>	<u>10</u>
1:00-5:00	The Road to CRS Class One—The Tulsa Story (\$45) <i>Instructors: Bill Robison, PE, CFM, Robison Consulting Service, Inc. and David Arkens, CFM, Insurance Svcs. Office, Inc.</i>	<u>11</u>
1:15-3:30	<u>NATIONAL POLICY DISCUSSIONS</u> Coastal Issues 14 Flood Insurance.....15 Higher Education19 Stormwater Mgmt., No Adverse Impact, Natural & Beneficial Functions.....20 Nonstructural Floodproofing21 Arid Regions22	
3:00-3:15	First Timers Orientation	<u>Reg</u>
3:00-5:00	CTP Conversation	<u>24</u>
3:30-4:00	BREAK	<u>Exhibit Level</u>
4:00-5:00	ASFPM Members Meeting	<u>25 AB</u>
4:00-7:00	CFM Exam (pre-registration required)	<u>26 A</u>

- 5:00-7:00 **Exhibits Grand Opening/ Social** Exhibit Hall C
Sponsored by: FM Approvals
- 5:00-7:00 **Silent Auction** Exhibit Hall C
 17th annual fundraising activity sponsored by the ASFPM Foundation. All proceeds for this year's auction will go to the Future Leaders Scholarship fund.
- 7:00.... Dinner on your own, enjoy Cleveland!

Day 2: Tuesday, May 21

- 7:00-7:00 **Exhibit Hall Hours** Exh
 7:00-5:00 **Registration Desk** Reg
 7:30-5:00 **Speaker Prep Lounge** 2
 7:45-8:30 **Continental Breakfast** Exh
- 8:30-10:00 **PLENARY SESSION** BR
Welcome Address: Chad Berginnis, CFM, ASFPM Executive Director; Maria Cox Lamm, CFM, ASFPM Chair, SC DNR
Building Resilience
1. Engineering with Nature for Resilience and Value Creation. Todd Bridges, Ph.D., Senior Research Scientist, Environmental Science, U.S. Army Engineer Research and Development Center, USACE
2. Groundbreaking Building Code Awareness Through Consumer Research—The No Code No Confidence Campaign. Leslie Chapman-Henderson, President and CEO, Federal Alliance for Safe Homes (FLASH)
3. Mark Osler, Senior Advisor for Coastal Inundation and Resilience Science and Services, NOAA
Moderator: Maria Cox Lamm, CFM, ASFPM Chair, SC DNR
- 10:00-10:15 **First Timers Orientation** Reg
 10:00-10:30 **Break, Exhibits, Silent Auction** Exh

10:30-Noon CONCURRENT SESSION A

- A1** **Flood Risk Communication After Wildfires** 13
 Moderator: Ellen Berggren, PMP, CFM, USACE Institute for Water Resources
#FloodAfterFire – An Analysis on Improving Modern Community Engagement and Communications. Francie Israeli, Resilience Action Partners
Burn Scars as Building Blocks: Lessons Learned From Flood-After-Fire Risk Communications. Eugene Kinerney, DHS/FEMA/FIMA/ Federal Insurance Directorate
Building Community Resilience Through Effective Risk Communication. Lawrence Frank, CFM, Atkins
- A2** **Social Justice Factors in Floodplain Management** 14
 Moderator: Robyn Fennig, CFM, Wisconsin Emergency Management
Socially Vulnerable Populations: Under-Recognized Victims of Flooding Disasters. Jo Ann Howard, H2O Partners
Socioeconomic Factors Affecting Coastal Communities' Participation in CRS. Alexis Cunningham, CSO & ASFPM,
Equity & Social Justice: What King County, Washington is Doing to Manage Floodplains More Equitably. Mitch Paine, CFM, King County

- A3** **Coastal Resilience Planning and Projects** 15
 Moderator: Dan Tomczak, CFM, Jacobs
Ridge to Reef and Beyond – the Challenges and Opportunities of Hazard Mitigation in the U.S. Virgin Islands. Colin Vissering, AICP, CFM, Witt O'Brien's
Evaluating the Vulnerability of Infrastructure to Coastal Storms - A Case Study. Michael Vecchio, PE, HDR
Innovative Coastal Flood Resiliency in Urban Environment: Red Hook Integrated Flood Protection System in NYC. Rahul Parab, PE, D.WRE, CFM, Dewberry
- A4** **State Mapping Initiatives** 19
 Moderator: Whit Montague, CFM, Arkansas Natural Resources Commission
Floodplain mapping without (largely) FEMA – the Indiana Floodplain Mapping project. David Knipe, P.E., CFM, Indiana DNR
The Maryland Resiliency Partnership: State Collaboration takes Risk MAP to New Levels. Dave Guignet, Maryland Department of the Environment
New Vermont Mapping, Regulation, and Training to Enhance Floodplain Protection. Rob Evans, CFM, VT Dept. of Environmental Conservation
- A5** **When Hurricanes (In)Validate Models** 20
 Moderator: Ed Capone, EIT, CFM, NWS Norton/Boston Northeast River Forecast Center

- A6** **FEMA/Corps Levee Safety Session** 21
Moderator: Tammy Conforti, PE, CFM, USACE
The Levee Safety Reunion Tour: Bringing the Band Back Together. Tammy Conforti, PE, CFM, USACE and Suzanne Vermeer, PE, CFM, FEMA
- A7** **Local Stream Restoration Case Studies** 22
Moderator: Kristin Owen, AICP, CFM, Virginia Department of Conservation & Recreation
West Water Run Stream Restoration and Flood Mitigation Project. Miles Hebert, PE, LEED Green Associate, CFM, EMH&T
Reducing Flood Risk by Restoring Natural Processes: The Sidney Greenplain Project. James Woidt, PE, Shumaker Consulting Engineering and Land Surveying, DPC.
Incorporating Natural Floodplain Functions into Mitigation. Panelists: Eileen Shader, CFM, American Rivers; Mike Kline, Vermont Rivers Program; Dave Fowler,

DCL, CFM, ASFP; Joel Freudenthal, Yakima County Flood Control District, WA

- A8** **Michael Baker International Showcase: Building Resilient Communities: Change Starts from Within** 23
Moderator: Chrissy Caggiano, AICP/PP, Resilience Action Partners
Panelists:
 Kate Skaggs, Resilience Action Partners
 Anna Sierra, Caroline County Emergency Services
 Meg Bartow, Resilience Action Partners
- Noon-1:30 **ASFP Foundation Luncheon** BR
Moderator: Doug Plasencia, PE, CFM, ASFP Foundation President, Moffatt & Nichol
 Come to learn about some of the activities your donations to ASFP Foundation have supported during the past year, including the Future Leader Scholarship, the Student Paper Competition and the Rocky Mountain Environmental Challenge.
- 1:00-5:00 **TECHNICAL TOUR (\$)** Bus
Rockin' Projects in Euclid Creek (\$45)
- 1:30-
 1:30-5:30 **TRAINING WORKSHOPS (\$)**
State Floodplain Manager 1 on 1 Mentoring Workshop 12
Instructors: Al Goodman, CFM, AWG Consulting, LLC; Bill Nechamen, CFM, Nechamen Consulting, LLC

- 1:30-5:30 **New FEMA P-784, Substantial Damage Estimator Version 3.0 (\$45)** 10
Instructors: Jennie Pepper, AECOM and Aaron Rupp, PMP, CSM, AECOM
- 1:30-5:30 **Incorporating Natural Floodplain Functions into Mitigation (\$45)** 11
Instructors: Eileen Shader, CFM, American Rivers; Mike Kline, Vermont DEC Watershed Management Division; and Dave Fowler, DCL, CFM, ASFPM
- 1:45-3:15 **ASFPM Chapter Meeting** 25 A
- 1:45-3:15 **CONCURRENT SESSION B**
- B1 Research Findings and Risk Communication** 13
Moderator: Jeremias Alvarez, PMP, CSM, CCMP, Guidehouse
Leveraging Behavioral Insights to Improve Messaging and Increase Insurance Coverage. Shrupti Shah, Deloitte
The Evolution of Communicating Risk: A Conversation with FEMA's Data and Communications Branch. Priscilla Scruggs, FEMA
Why take a rational approach to a predictably irrational problem? Understanding the role of mental shortcuts and cognitive biases in the way our brains process risk and probability. Kristin Murphy, ICAgile Certified Professional, Level 4 Social Marketer (CIM), Booz Allen Hamilton

- B2 Holistic/Watershed Floodplain Management** 14
Moderator: Molly O'Toole, PE, D.WRE, CFM, Molly O'Toole & Associates, Ltd.
Louisiana Watershed Initiative - Working Together for Sustainability and Resilience. Jeffrey Giering, CFM, State of Louisiana
The Puyallup Watershed: A Case Study in Integrated Floodplain Management. Spencer Easton, CFM, Environmental Science Associates
Learn How FEMA-USFWS-NMFS Partner to Promote Conservation of Threatened and Endangered Species. Bret Gates, FEMA Mitigation
- B3 FEMA Hazard Mitigation Grants and Policy** 15
Moderator: Katie Sommers, CFM, Wisconsin Emergency Management
HMA Application Development and Review – Applying Best Practices and Lessons Learned. Manuel Perotin, PE, CFM, CDM Smith
FEMA Mitigation and Disaster Grants – Facts, Myths and Legends. Matt Jadacki, CPA, CGFM, EY
Seeking Higher Ground: Timeframes and Characteristics of FEMA-Funded Floodplain Buyouts. Anna Weber, Natural Resources Defense Council
- B4 CTP Showcase** 19
Moderator: Maribel Marquez, PE, PMP, CFM, ESP Associates

Leveraging Technical Assistance to Enhance Local Awareness and Mitigation Through Risk MAP. Tom Morey, RS, CFM, Stantec
Flood Risk CHAMPions. Rigel Rucker, PE, CFM, AECOM
Lessons from the Field, CTP Program Project Management Best Practices. Laura Algeo, PE, FEMA HQ

B5 Identifying and Mitigating Building-Specific Risk 20
Moderator: Jeff Sparrow, PE, CFM, Moffatt & Nichol
Floodplain Buyout Program Prioritization Using Community-wide Watershed Models. Stephen Sands, PE, CFM, Hazen and Sawyer,
The Nuts & Bolts of Probabilistic Modeling (and why it's awesome). Geoff Uhlemann, PE, CFM, AECOM
Incorporating Uncertainty of First Floor Elevations into Flood Risk Assessment Modeling. Shane Parson, PhD, PE, CFM, AECOM

B6 Stormwater Management at the Watershed Level 21
Moderator: Joe Walter, PE, Atkins
Evaluating and Selecting Release Rates for Specific Watersheds in Cook County. Amanda Flegel, PE, CFM, Illinois State Water Survey
Stormwater Management: A Regional Approach. Janet Popielski, PE, Northeast Ohio Regional Sewer District

Stormwater Master Plan Solutions: Stream Flooding/Erosion Mitigation in the Cuyahoga River Watershed. John Aldrich, PE, D.WRE, CDM Smith

B7 Post-Disaster Tech 22
Moderator: Michael Grasso, CFM, CDM Smith

Artificial Intelligence: Pioneering New Tools for Efficient Flood Damage Estimation. Benjamin Roberts, ASA, ABS Group

NASA Disasters Program Support of Hurricane Florence Response. Garrett Layne, NASA Earth Science Disasters Program

Rapid Deployment of Small Unmanned Aerial System (sUAS) for Post-Hurricane Disaster Assessment. Victor Acosta, T&M Associates (Compass JV)

B8 AECOM Showcase: 23
On the Main Stage: Big Base Level Engineering Data: Big Opportunities, Big Benefits, Big Challenges

Moderators: Lillian Robison, CFM, PMP, AECOM and Doug Bellomo, PE, AECOM
Panelists:

Jennifer Moss, CFM, AECOM
Alicia Silverio, CFM, Ohio Department of Natural Resources
Michael Taylor, PE, CFM, PMP, AECOM
Aaron Carranza, PE, CFM, North Dakota State Water Commission
Brandon Banks, GISP, AECOM

Map and Center Overview

Huntington Convention Center of Cleveland and Global Center for Health Innovation

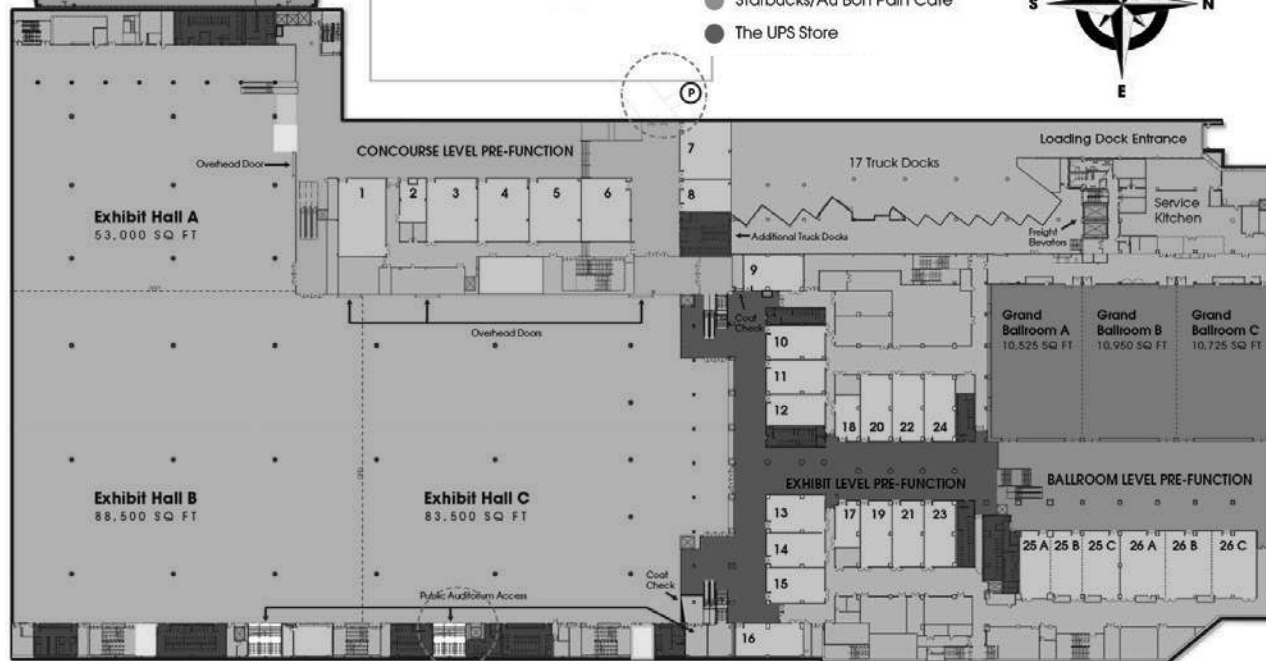

- Exhibit Halls
- Ballrooms
- Meeting Rooms
- Concourse Level
- Exhibit Hall Level
- Ballroom Level
- Exhibit Hall Concessions
- Show Offices
- Starbucks/Au Bon Pain Cafe
- The UPS Store
- Public Restrooms
- Back of House
- Elevators
- Campus Connections
- Ⓟ Huntington Park Garage



- 3:15-3:45 **Break, Exhibits, Silent Auction** Exh
- 3:45-5:15 **9th Annual ASFPM Foundation Student Paper Competition** 25 B
Judges: ASFPM Foundation Trustees
"A Win-Lose Situation for Floodplain Buyouts: Exploring the Impacts of Floodplain Buyouts on Participants in the State of Illinois" Jasmine Thomas, University of Illinois, Urbana-Champaign.
"Disaster Exposure and Migration: The Impact of Major and Minor Flood Events on Population Loss." Nora Louise Schwaller and Jordan Branham, University of North Carolina, Chapel Hill.
- 3:45-5:15 **CONCURRENT SESSION C**
- C1 **Flood Risk Disclosure: Intersection of Regulations and Risk Communication** 13
Moderator: Samantha Medlock, CFM, Willis Towers Watson
Improving Disclosure Laws so Home Buyers are Not Kept in the Dark about Flood Risk. Joel Scata, Esq, Natural Resources Defense Council
Engaging Real Estate Agents in Flood Risk Communication. Lisa Foster, CFM, Pinellas County
Dam Ownership Risks and Burdens: Raising Public Awareness through Educating Real Estate Agents. Kent Wilkins, CFM, OWRB

C2

- CRS: National and State Perspectives** 14
Moderator: Vikram Shrivastava, PE, PMP, D.WRE, CFM, Atkins
Community Rating System Update: Plain and Simple! Bill Lesser, CFM, FEMA
How State Assistance with GIS Helps Communities Say 'Yes' to CRS. Martin Koch, CFM, Kansas Dept. of Agriculture - Division of Water Resources
One Dose of DMA and Two Doses of CRS: A "Cure" for a Successful Hazard Mitigation Plan. David Stroud, CFM, Wood

C3

- Professional Research on Hazard Mitigation Policy** 15
Moderator: Mike Pavlides, F.SAME, CFM
Flood Mitigation and Sea Level Rise Adaptation Driven by Municipal Credit Rating. John Miller, P.E., CFM, CSM, DHS-FEMA
Pluvial Flood Risk. Jeffrey Czajkowski, PhD, Wharton Risk Management and Decision Processes Center
Profiles in Flood Mitigation: Overcoming Barriers to Designing and Implementing Effective Policies. Evan Chapman, The Pew Charitable Trusts

C4

- Mapping Urban Flood Risk** 19
Moderator: Jacob Tysz, CFM, Atkins
Who'll Map the Rain? Capturing Pluvial Flood Risk. Siamak Esfandiary, Ph.D., P.E., FEMA
Equity and Resilience in Urban Flooding: The Elephant in the Room. Elise Ibendahl,

PE, CFM, ENV SP, Jacobs Engineering
Flooding Outside the Lines: Applying TWI to the Problem of Urban Flooding. Kingsley Allan, GISP, CFM, Univ. of IL / Illinois State Water Survey

C5 Creative Methods for Real-Time Forecasting 20

Moderator: Mathew Hornack, PE, CFM, ESP Associates Resources Engineering, LLC

Adapting National Water Model Forecast Data to Local Hyper-Resolution H&H Models. Peter Singhofen, PE, Streamline Technologies, Inc.

"Hurry"cane Modeling: Forecast Modeling to Optimize Limited Resources with Limited Time. Ed Dickson, PE, CFM, Freese and Nichols, Inc.

PSEG-LI Stormsurge Flood Modeling and Flood Mapping for Long Island New York using waterRIDE™. Efrain Giron Maglioni, PhD, P.Eng., Advisian/WorleyParsons

C6 Mapping Dam and Levee Risk 21

Moderator: Bo Juza, PhD, CFM, Aquatrend, LLC

Reaching Milestones in Mapping Non-accredited Levees. Michael Seering, PE, CFM, PMP, AECOM

Uses of DSS-WISE to support Risk Map: Tips, Tricks and Tools for Rapid Inundation Risk Modeling. Tiffany Coleman, PE, CFM, STARR II (Stantec)

A GIS-Based Tool to Prioritize FEMA Levee

C7

Mapping Updates. Kim Dunn, D.WRE, PE, CFM, T&M Associates, Compass JV

Lessons Learned for Substantial Damage Determinations 22

Moderator: Shannon Riess, CFM, Florida Division of Emergency Management
Substantially Damaged...Again. Dan Brubaker, PE, CFM, NC Dept of Public Safety

Substantial Damage: the Good, the Bad, and the Ugly. Jessica Artz, CFM, SC DNR
Answers to Questions about Substantial Damage in the Post-Disaster Environment. John Ingargiola, EI, CBO, CFM, FEMA HQ Building Science

C8

FEMA Showcase 23

Moderator: Eric Letvin, PE, Esq.

NFIP/Endangered Species Act Update.

Bret Gates

DRRA Update. Kaye I. Lakhia, AIA, NCARB, LEED AP, CFM

State Assessment Notifications. Adrienne Sheldon, PE, CFM

Building Science Update. Dan Bass, AIA

Building Science Update. John Ingargiola, PE, CFM

5:15-7:00

Exhibits Social, Silent Auction Exh
Sponsored by: STARR II

7:00-

Dinner on your own – enjoy Cleveland!

Day 3: Wednesday, May 22

7:00-3:30 **Exhibit Hall** Exh
 7:00-5:00 **Registration Desk** Reg
 7:30-5:00 **Speaker Prep Lounge** 2
 7:45-8:30 **Continental Breakfast** Exh

7:00-10:00 **7th Annual Running of the Chapters 5K Run/Walk** Bus

8:30-10:00 **PLENARY SESSION** BR
National Flood Insurance Program: Reauthorization and Implementation Issues. Panel Members:
 1. **Austin Perez**, Senior Policy Representative, National Association of REALTORS® (NAR)
 2. **Susan Asmus**, Senior Vice President of Regulatory Affairs, National Association of Home Builders (NAHB)
 3. **Rob Moore**, Director, Water & Climate Team, Natural Resources Defense Council (NRDC)
 4. **David Maurstad**, Deputy Associate Administrator for Insurance and Mitigation; Chief Executive of the NFIP, FEMA
Moderator: Chad Berginnis, CFM, ASFPM Executive Director

10:00-10:30 **Break, Exhibits, Silent Auction**
FINAL Silent Auction Bids at 10:30am! Exh

10:30-Noon **CONCURRENT SESSION D**

D1 Innovations and Technology in Risk Communication 13

Moderator: Jamelyn Austin Trucks, CGM, CFM, Atkins

Next Generation Information and Communication Systems for Flooding.

Ibrahim Demir, PhD, University of Iowa

Making Mitigation Mainstream.

Peter Herrick, Jr., FEMA (HQ)

The Observed Flood Extent: Using Multispectral Satellite Imagery to Detect and Map Historical Flood Events.

Catherine Ipsan, Radiant Solutions

D2 Flood Insurance Rating 14

Moderator: Bruce Bender, CFM, Bender Consulting Services, Inc.

Risk Rating Redesign: Progress to Date and Next Steps. Andy Neal, FSA, FEMA/FIMA.

National Flood Insurance Program

Pricing. Phillip Dunn, ANFI, National Flood Services

Flood Impacting Threshold, FITS™ Scores, InstaScore, and PrecisionRating™: New

and Powerful Tools for Differentiating

Flood Risk. John Sun, Stream Methods, Inc.

D3 Risk Assessments to Transportation Infrastructure Resilience 15

Moderator: Randall Behm, PE, CFM, Behm Hazard Mitigation, LLC

How Critical is Access to Key Facilities in a Flood Event? Janey Camp, PhD, PE,

GISP, CFM, Vanderbilt University
Measuring Transportation Infrastructure Resilience: A Case Study with Amtrak.
 Gina Tonn, PhD, PE, CFM, Delaware
 Department of Natural Resources and
 Environmental Control
**Assessing the Vulnerability of
 Transportation Infrastructure to Climate
 Stressors in San Diego, California.**
 Jeffery Crump, PE, Moffatt & Nichol

D4 Mapping Issues with Sea Level Rise and Coastal Erosion 19
 Moderator: Doug Marcy, NOAA Office for
 Coastal Management
**30-Years of FEMA Sea Level Rise Studies
 and Future Focus Areas.** Brian Batten,
 PhD, CFM, Dewberry
**Great Lakes Coastal Flood Hazard Studies
 Are More Than Meets the Eye.** Ken
 Hinterlong, FEMA Region V
**Modernizing Coastal Erosion and the
 Primary Frontal Dune.** Christina Lindemer,
 FEMA

D5 Modeling for Local Flood Risk Planning 20
 Moderator: Ben Pylant, PE, CFM, Half
 Associates
**Lisbon Flooding Problematics - Proactive
 Decision-Making Supported by a Novel
 Integrated Numerical Modeling
 Approach.** Rodrigo Fernandes, PhD.,
 MSc., Senior Consultant, Bentley Systems,
 International Limited,
Regional Flooding Challenges and

**Approaches – City of Canfield Bradford-
 Briarcliff Flood Mitigation Study.** Chad
 Boyer, PE, CFM, ms consultants, inc.
**Two-Dimensional Floodplain Modeling in
 Downtown Baltimore.** Sravan Krovdi, PE,
 CFM, Wood E&IS

D6 Stormwater Asset Management Tools 21
 Moderator: Vince DiCamillo, PMP, CFM,
 Stantec
**An Urban Stream Manager's Guide to
 Field-Based Master Planning.** George
 Remias, PE, NEORSD
**GIS Showcase: FPA Tools for Stormwater
 Management.** Chris Hill, GISP, CFM,
 Meshek & Associates, LLC
**Enhancing Your Asset Management
 Strategy - Innovative Approaches in
 Stormwater Asset Collection and
 Evaluation.** Neal Banerjee, PE, CFM, ESP
 Associates, Inc.

10:30-Noon FEMA State Roundtable BR
 This FEMA/state roundtable discussion will
 focus on the continued transformation of
 the CAP-SSSE grant program and the
 new BRIC program. This event is only for
 state floodplain managers, state hazard
 mitigation officers and their staff.

**Noon-1:30 Open lunch (on-site concessions
 available for purchase in exhibit hall)**

12:20-1:30 Lunch with CRS 11

Again this year, the CRS will be hosting a "Lunch with CRS" at the ASFPM National Conference. NFIP State Coordinators and CRS State Coordinators, and CRS users group leaders, are invited to gather with members of the CRS Team from FEMA and ISO for a brown bag lunch (**bring your own lunch**). Community CRS Coordinators and floodplain managers are also invited to join the conversation.

12:30-1:30 **Chapter Networking Lunch** 10

Grab a lunch and bring it to this new event. ASFPM Chapter Directors representing all 5 chapter districts will be present to meet with chapters over lunch. This is a great opportunity to learn more about ASFPM's plans to improve chapter benefits and to network with other chapters

1:30-3:00 **CONCURRENT SESSION E**

E1 **State and Local Risk Communication Initiatives 1** 13

Moderator: Ellen Berggren, PMP, CFM, USACE Institute for Water Resources
Denver FloodWalk: Visualizing Flood Risk in an Urban Park. Tony Mendes, CFM, FEMA
Letting it Flow: Sharing Local Stories that Inspire Personal Mitigation Action. Kate Skaggs, CFM, Resilience Action Partners (Baker)
Digital Outreach and Education for Rural

Communities. Lee Beshoner, PE, CFM, FTN Associates FEMA

E2 **Floodplain Management Policy and Regulations** 14

Moderator: Steve Samuelson, CFM, Kansas Department of Agriculture
The BFEs Are(n't) All Right: An Assessment of Elevation Certificates and Implications to the NFIP. Jennifer Marcy, CFM, Atkins
A Cumulative Standard for Substantial Improvement: Our Rocket to the Moon. Tom Leatherbee, MCP, AINS, CFM, City of Del City
Managing Urban Floodplains in Fort Worth, Texas. Clair Davis, PE, CFM, City of Fort Worth

E3 **Mitigation through Better Building Performance** 15

Moderator: Michelle Gonzales, CFM, Rostan Solutions, LLC
Evaluating your FPM building design and construction requirements in a post-disaster environment. Manuel Perotin, PE, CFM, CDM Smith
Building Performance and Outreach after the Recent Hurricanes. Daniel Bass, RA, CFM, FEMA HQ Building Science
Predicting Flood Damage using Probability Theory. William Coulbourn, Coulbourn Consulting

E4 FEMA Mapping Tools and Resources 19
Moderator: Jessica Baker, PE, CFM, PMP, Halff
FEMA Flood Map Tools for Floodplain Managers. Daniel Horner, CFM, CSM, NiyamIT.
Capturing Data Delivery on the FEMA GeoPlatform. Marshall Rivers, PMP, CFM, STARR II (Atkins)
Supporting Local Government through Advisory Products and GIS Analysis. Naomy Perez-Sanchez, Atkins, SNC Lavalin member

E5 2D Modeling for State Programs 20
Moderator: Alejandro Riano, PE, CFM, AECOM
Regulating 2D Models – Opportunities and Lessons Learned from CHAMP. Isaac Allen, EI, CFM, AECOM
The Future of BLE Data: How Louisiana is Using BLE Data to Supplement Their CTP Program. Jacob Lesue, PE, CFM, Dewberry
Moving Forward in Kentucky: Approaches to 2D Modeling and Risk MAP Integration. Tommy Arnsperger, AECOM

E6 Dam and Levee Systems Management 21
Moderator: Onur Celik, PE, CFM, PMP, CDM Smith
Interfaces between Earthen Levees and Hard Structures: Understanding and

Managing their Performance. Jonathan Simm, PhD, CEng, HR Wallingford
Estimating and Evaluating Spillway Capacities of Guadalupe Valley Hydroelectric System Dams on Guadalupe River, Texas. Hui-Ming "Max" Shih, Ph.D., PE, CFM, CDM Smith
Dam Rehabilitation Grant Program-Incorporating mitigation and floodplain management to reduce risk. Edward Beadenkopf, PE, CFM, STARR II (Atkins)

E7 Restoring Natural and Beneficial Functions 22
Moderator: Sally Cook, CFM, Manatee County Building & Development Services (FL)
Healthy Wetlands, Healthy Watersheds: Leveraging state wetland restoration and protection programs to improve watershed health. Marla Stelk, Assoc. of State Wetland Managers
Restoring More Natural and Beneficial Functions of Floodplains. Brad Gordon, American Rivers
The Floodplain Explorer: Prioritizing Floodplain Restoration in the Mississippi River Basin. Kris Johnson, PhD, The Nature Conservancy

E8 Sea Level Rise Adaptation 23
Moderator: Amy Carlson, PE, Jacobs
Retreating for Resilience: Legal and Policy Tools for Relocating Development from Floodplains. Katie Spidalieri, Attorney, Georgetown Climate Center

Adapting to Climate Change vs Traditional Flood Mitigation – What's the Difference? Vince Geronimo, PE, CFM, Mead & Hunt
U.S. Federal Climate Resiliency Policy: Is It Advancing or Retreating? Sarah Murdock, The Nature Conservancy

- E9 State Day - Mitigation** 12
 Moderator: Jennifer Nelson, Minnesota Homeland Security and Emergency Management
Ready, Set, ASSESS! How to Conduct a Meaningful Risk Assessment with Limited Resources. Tom Hughes, CFM, Pennsylvania Emergency Management Agency
Community Technical Assistance: A Model for Mitigation Action. Tara Lanzrath, CFM, Kansas Department of Agriculture
Successfully Integrating Climate Adaptation into the Massachusetts Hazard Mitigation Plan. Joy Duperrault, CFM, Massachusetts Dept. of Conservation & Recreation

3:00-3:30 **Break, Final Exhibits Viewing** Exh

- 3:30-5:00 **Natural Floodplain Functions Alliance Meeting** 11
 The Natural Floodplain Functions Alliance (NFFA) is an affiliation of nonprofit and private organizations, government agencies, and individuals dedicated to the protection and preservation of the

natural functions of floodplains, including coastal areas. To support its mission to share information and promote collaboration, the NFFA is hosting a discussion session open to members and other interested parties. Topics will include short updates on key Federal policies, benefit cost analysis for natural infrastructure, levy setbacks, Vermont's Floodplain Initiative, and more. All are welcome to attend!

3:30-5:00 CONCURRENT SESSION F

- F1 Local Flood Warning Systems** 13
 Moderator: Sarah Jamison, NWS Forecast Office – Cleveland
Utilizing Technology, Partners, and Communication for Mitigating Flood Impacts. Mark Link, Northeast Ohio Regional Sewer District
North Central Texas Collaborates on Flood Warning: A Cooperative Success Story. Mia Brown, CFM, North Central Texas Council of Governments
The Future Is Now: Flood Forecasting in Harris County, Texas. Andy Yung, PE, D.WRE, CFM, Walter P Moore and Associates

- F2 Guidance for Local Floodplain Administrators** 14
 Moderator: Charla Marchuk, CFM, FEMA
Floodplain Forms: Floodplain Management Streamlined. Joshua Lippert, CFM, City of Philadelphia

Navigating the New EC: Understanding the Changes and Updates to the FEMA Elevation Certificate. Del Schwalls, PE, CFM, Schwalls Consulting LLC
Floodplain Management within a 2D Floodplain/Floodway Special Flood Hazard Area. Stephen Noe, Wood

F3 Floodproofing Successes 15
 Moderator: Dan Clevidence, CFM, Ohio Emergency Management Agency
Dry-floodproofing: Recent Case Studies in NYC. James P. Colgate, Esq., AIA, CFM, Bryan Cave Leighton Paisner LLP
Stories of Resilience: How Smart Companies Out-Smart Floods. Jens-Uwe Thalheim, PhD, FM Global
Floodproofing Critical Infrastructure: the Tacoma Central Treatment Plant Flood Protection Project. Tyler Jantzen, PE, Jacobs

F4 Advances in Mapping 19
 Moderator: Jacob Hoover, AICP, CFM, Ohio Emergency Management Agency
LOMA's for the Masses – A quick guide to multiple LiDAR LOMAs. Tim Benenati, CFM, AECOM
MAAPnext – A next step to Evolving Floodplain Mapping. Ataul Hannan, PE, CFM, Harris County Flood Control District
Informing floodplain management and hazard communication through probabilistic flood inundation maps. Tim Stephens, University of Georgia

F5 Modeling Waves and Coastal Erosion 20
 Moderator: Lori Cary-Kothera, NOAA Office for Coastal Management
Wave Overtopping - A Key Piece in Predicting Coastal Flood Hazards. Matt Shultz, PE, Woods Hole Group
Modeled Storm Impacts Validated: Lake Ontario Spring 2017 Flooding Event. Jeff Gangai, CFM, Dewberry
Modeling and Mapping Applications for Wave Overtopping on the Great Lakes. Rebecca Aiken, EIT, CFM, Stantec

F6 Local Holistic Stormwater Management Approaches 21
 Moderator: Susan Cleverley, CFM, Idaho Office of Emergency Management
Using Regional Stormwater Solutions to Promote Quality Sustainable Development. Tom Jacobs, PE, CFM, City of Lenexa, KS
7th Avenue Creek Flood Mitigation and Flood Reduction Master Plan: Developing a Plan to Meet Multiple Objectives and Funding Opportunities. Ajay Jain, PE, CFM, HR Green, Inc.
Robbins, IL : Re-imagining Stormwater Investment. Richard Fisher, PE, CFM, Metropolitan Water Reclamation District of Greater Chicago

F7 Post-Disaster Responses to Recent Events 22
 Moderator: Erin Mack Ashley, PhD, LEED AP, Atkins

Emergency Home Repairs Virgin Islands – Creating the Program Identity to Achieve Success. Ann Terranova, CFM, AECOM
Implementation of Hazard Mitigation under the Sector-Based Approach in Puerto Rico. Devin Schultze, EIT, CFM, CDM Smith
Positioning Mitigation Success in Puerto Rico Post-Maria. Andrew Martin, FEMA Region II

F8 Coastal Decision Support Tools 23

Moderator: Claire Jubb, AICP, CFM, Charlotte County Community Development (FL)
Coastal Barrier Resources System Tools and Data Updates from the USFWS. Dana Wright, U.S. Fish and Wildlife Service
Adapting Stormwater Management for Coastal Floods. Douglas Marcy, NOAA Office for Coastal Management
Community Involvement with the Monitoring of Water Levels and King Tide Events. Daniel Tomczak, CFM, Jacobs Engineering Group

F9 State Day - NFIP 12

Moderator: Sue Baker, CFM, Maine Dept. of Agriculture, Conservation & Forestry
SCORE CAVs - A New Strategy on Building Regional and Statewide Flood Resiliency. Shannon Riess, State Floodplain Management Office, Program Manager
First Steps to Correcting Violations. Steve Samuelson, CFM, KS Dept. Agriculture
The EMAC Solution to Floodplain

Recovery. Traci Sears, CFM, State of Montana

5:30-7:30

**ASFPF Foundation Donor 25AB
 Appreciation Reception & Live Auction**
(Ticket required)

Foundation donors have received invitations with tickets to this event. Tickets for this event are available for purchase at \$125 each at the ASFPF Foundation Silent Auction tables in the Exhibit Hall.

5:00....

Dinner on your own, enjoy Cleveland!

Day 4: Thursday, May 23

7:00-5:00	Registration Desk Hours	<u>Reg</u>
7:30-5:00	Speaker Prep Lounge Hours	<u>2</u>
7:45-8:30	Continental Breakfast	<u>Exhibit Level</u>
8:00-2:00	Silent Auction Pickup	<u>16</u>

8:30-10:00	<u>PLENARY SESSION</u>	<u>BR</u>
	Making It Work: Flood Risk Management - Best Management Practices	
	1. Ohio Mitigation Success Stories. Steve Ferryman, CFM, State Hazard Mitigation Officer, Ohio Emergency Management Agency	
	2. A Successful Substantial Damage Program 4 Years in the Making. Maria Cox Lamm, CFM, ASFPM Chair, South Carolina DNR	
	3. New Partnerships in the Floodplain Make it Work. Skip Stiles, Executive Director, Wetlands Watch	
	Moderator: Tim Trautman, PE, CFM, Program Manager, Mecklenburg Cnty., NC	

10:00-10:30	Break	<u>Exhibit Level</u>
-------------	--------------	----------------------

10:30-Noon **CONCURRENT SESSION G**

G1	Communication During a Crisis	<u>13</u>
	<i>Jo Ann Howard, H2O Partners</i>	
	Communicating Flood Risk during Hurricane Florence in Eastern North Carolina. Belkys Melendez, National Weather Service	

NC FIMAN: Hurricane Florence Success Stories and Future Vision. Dan Brubaker, PE, CFM, NC Dept of Public Safety
Communicating the Risk from Coastal Storms: An Unresolved Issue. Guillermo Simón, PE, CFM, Taylor Engineering, Inc.

G2	Local CRS Successes	<u>14</u>
	<i>Moderator:</i> Josh Overmyer, CFM, Charlotte County Community Development (FL)	
	Success with CRS: Lessons from Class 2 Communities. Dennis Dixon, CFM, Pierce County (WA)	
	Class 5 CRS Community – It Can be Done. Maggie Talley, CFM, Jefferson Parish	
	Repetitive Loss Area Analysis: Why Everyone Needs One. Marilyn Sucoe, PE, CFM, IDNR/OWR	

G3	Hazard Mitigation and Resilience Planning	<u>15</u>
	<i>Moderator:</i> Darin Punchard, AICP, CFM, Punchard Consulting	
	David, Meet Goliath: How Small Communities are Facing Down Big Flood Issues. Mike Robinson, CFM, Moffatt & Nichol	
	Integrating Natural and Nature-based Infrastructure into Hazard Mitigation Plans: Creating Resilient and Sustainable Communities. William "Drew" Parker, CFM, GISP, USEPA	
	A Resilient Rancheria: Using Hazard Mitigation Plans to Centralize Information	

for Funding. Caroline Cunningham, AICP, ABCP, CFM, Stantec

- G4 Predictive Inundation Mapping** 19
 Moderator: Bunny Bishop, CFM, Nevada Division of Water Resources
Advanced Forecasting and Mapping of Catastrophic Flood Inundation in South Carolina. Maria Cox Lamm, CFM, South Carolina DNR
Leverage it! Part 1: Models, Gages, and Topo... Forecasting Flood Damage. Kimberley Piri, PE, CFM, AECOM
Mapping the Flood Forecast – USACE Case Studies from 2017 and 2018 Hurricanes. Jason Sheeley, GISP, U.S. Army Corps of Engineers

- G5 Leveraging Existing Data for Large Scale Modeling** 20
 Moderator: Elise Ibendahl, PE, ENV SP, CFM, Jacobs
Delivering Large Scale 2D Base Level Engineering Products in South Dakota. Amanda Banks, PE, PMP, AECOM
Enhancing Large-Scale 2D Hydraulic Models to Refined Local 2D Models with Floodways. Eli Gruber, PE, CDM Smith
Base Level Engineering: 2D Methods from the Mountains to the Plains. Chris Ide, PE, CFM, Wood

- G6 Complex Levee Projects** 21
 Moderator: Diana Castro, PE, CFM, Atkins
The Levee Vortex: Reaching Escape Velocity, Finally...Or Did We? Lalit Jha, PE,

D.WRE, CFM, JEO Consulting Group
The Intersection of Roads and Levees: Challenges of Managing Dual Infrastructure. Vicki Twerdochlib, PE, CFM, HDR
The Cannon Drive Levee: Flood Protection at The Ohio State University. Shawn Arden, PE, CFM, EMH&T

- G7 Sensors and Blockchain Applications in Floodplain Management** 22
 Moderator: Adam Lucas, PMP, CSM, Guidehouse
Enhanced Floodplain Management through the use of Widely Distributed Flood Sensor Networks. Ben Schreib, AECOM
Improving Dam Safety with Smart City Sensors. Patrick Heck, CSM, Guidehouse
Improving Flood Insurance Compliance, Monitoring, Claims Processing, and Risk Assessments using Blockchain Technology. Kerry Keys, Guidehouse

- G8 Urban Flooding Mitigation Success** 23
 Moderator: Phetmano Phannavong, PE, CFM, Atkins
Preparing for the New Normal and Challenging the Process for Integrated and Large Scale Solutions for Mitigation. Jamelyn Austin Trucks, CFM, CGM, Atkins
Flood Mitigation in Huntsville, AL: Using HMGP to Mitigate Urban Flooding. Byron Hinchey, PE, S&ME, Inc.
56th & Morton – Lincoln, NE - Flood Mitigation Takes Time, Money, and

Cooperation: A Story of Persistence. Kevin Kruse, PE, JEO Consulting Group, Inc.

Noon-1:45 **ASFP National Awards Luncheon** BR
....and invitation to the ASFP 2020 Conference in Fort Worth, Texas June 7-11, hosted by the Texas Floodplain Management Association
Sponsored by: Guidehouse

1:00-5:00 **TECHNICAL TOUR (S)** Bus
Green Infrastructure Gig (\$45)

2:00- **TRAINING WORKSHOPS (S)**

2:00-4:00 **Resilience Scorecard: How to Evaluate Networks of Plans (\$45)** 10
Instructors: Jaimie Masterson, AICP, Institute for Sustainable Communities/Texas A&M and Justin Kates, CEM, City of Nashua, NH

2:00-4:00 **LOMR/CLOMR Process Best Practices for a Successful Submittal (\$45)** 11
Instructors: Daven Patel, PE, CFM and Alex Haptermarium, PE, CFM, STARR/Stantec

2:00-4:00 **Building Coastal Resilience Through Capital Improvements Planning (FREE, pre-registration required)** 12
Instructor: Haley Briel, MS, ASFP

2:00-3:30

CONCURRENT SESSION H

H1 **Partnerships in Risk Communication** 13

Moderator: Steve Ferryman, CFM, Ohio Emergency Management Agency
The Together Project - Tiger Creek Nature Park: A New Paradigm. Kenneth Schwab, PE, CFM, City of Broken Arrow
Ohio Silver Jackets Flood Risk Management Success Projects. Ashley Stephens, CFM, USACE Huntington District
Sharing Leadership: Building Mitigation Coalitions that Do More than Just Talk. Jeffery Harvey, DEL, CEM, JH Consulting, LLC

H2 **Flood Insurance: Uses, Changes, and Reports** 14

Moderator: Kathy Holder, CFM, Utah Division of Emergency Management
Flood Insurance As a Tool Of Community Resiliency. Joe Rossi, CFM, ANFI, Massachusetts Coastal Coalition
Don't Stop Believin' - Believing in Change and our Commitment to Customers. Lloyd Hake, FEMA, Federal Insurance Directorate
The Office of the Flood Insurance Advocate (OFIA) 2018 Annual Report and Progress Report. Rhonda Montgomery, CFM, FEMA Office of the Flood Insurance Advocate

- H3 Advice and Lessons Learned for Flood Elevation Projects** 15
 Moderator: Bill Nechamen, CFM, Nechamen Consulting
Home Elevation is the Most Viable Option of Flood Mitigation. Sean O'Leary, CFM, SJ Hauck Construction
Simplifying FMA Projects by Removing the Locality from the Contracts. Kimberley Tempesco, CFM, City of Virginia Beach
Elevating Historic Homes. Larry Moss, AIA
- H4 CNMS Applications** 19
 Moderator: Patrick Heck, CSM, Guidehouse
Mapping the Unmapped: Where do we Start? Bradford Hartley Jr., GISP, CFM, Stantec Consulting Services, Inc.
CNMS for Coastal Risk Management, What communities need to know. Elena Drei-Horgan, PhD, CFM, AECOM
Submitting Flood Hazard Mapping Needs to FEMA and Tracking Flood Study Actions. Eliza Ledwell, CFM, IBM
- H5 Modeling for Transportation Design and Mitigation** 20
 Moderator: Lori Rafferty, PE, CFM, Louisville Metropolitan Sewer District
Overcoming Barriers in the Use of 2D Hydraulic Modeling. Scott Hogan, PE, FHWA
Testing the Waters: How H&H and Drainage Drive the Texas Bullet Train. David Rivera, PhD, PE, CFM, Freese and Nichols, Inc.

- Understanding Flood Resiliency in Princeville, North Carolina.** Allison Bryan, Moffatt & Nichol
- H6 Stormwater BMPs on the Horizon** 21
 Moderator: Terry Medley, PE, Kansas Dept. of Agriculture
Nature-Based Solutions to Flooding, Drought, and Groundwater Decline. Bryan Hummel, EPA Region 4
Experiences with Erosion Control Applications across the United States. Stefano Rignanese, Maccaferri Inc.
Green Stormwater Infrastructure for Increased Resiliency and Flood Risk Reduction. Kari Mackenbach, BCES, ENV SP, CFM, ms consultants
- H7 Natural and Beneficial Function Restoration and Floodplain Management** 22
 Moderator: Brian Caufield, PE, D.CE, CFM, CDM Smith
Targeted Stream Restoration. Ivan Valentic, ASLA, PLA, GPD Group
Case Studies of Floodplain and Stream Restoration Projects and their Potential Use for Flood Hazard Mitigation and Community Resilience. Rich Pfingsten, PWS, Stantec
Assessing floodplain function for more informed land use decision making. Stevie Adams, CFM, The Nature Conservancy

H8 Evaluating Complicated Hydrology 23

Moderator: Mark Forest, PE, CFM, HDR
Assessment of Uncertainty in Doppler Radar Estimated Precipitation. Valmir Buccaj, PhD, United States Military Academy at West Point
Application of Bulletin 17C on the Arkansas and Colorado Rivers. Brad Bettag, PE, CFM, Wood
Rethinking the Applicability of Current Flood Frequency Analysis for the 1% and 0.2% Events. Ted Cassidy, PE, PH, Dewberry

2:30-5:30 **CFM Exam** (pre-registration required) 25 B

3:30-4:00 **Break** Exhibit Level

4:00-5:30 CONCURRENT SESSION J**J1 State and Local Risk Communication 13**

Moderator: Christopher Budd, PE, CFM, Atkins
Comprehensive Floodplain Management and Mitigation Information at Your Fingertips. Patrick Dobbs, PE, Wood
Blue Moon: Kentucky's Contributions to FEMA's Moonshots. Carey Johnson, Kentucky Division of Water
A Tool to be "In The Know" Prior to Your Next Community Meeting. Darryl Rockfield, Jr., CFM, Missouri State Emergency Management Agency

J2 International Perspectives on Flood 14**Risk Management**

Moderator: David Powers, PE, PH, D.WRE, CFM, CDM Smith

Learning from Europe: Review of First Cycle of Implementation of Floods Directive. Richard Lewis, HR Wallingford
Flood Risk Management in Germany – The Impact of the EU-Flood Directive and Lessons Learned from the 2002 and 2013 floods. Klaus Piroth, PhD, CDM Smith Consult GmbH

Taking Levees into Account in Flood Maps: Comparing US and France. Anna Serra-Llobet, PhD, University of California, Berkeley

Risk Assessments 15

Moderator: Jake Gray, Tidal Basin Group
OpenHazus: the Future of FEMA's Hazus Loss Estimation Tool. Jesse Rozelle, GISP, FEMA HQ

"Show Me" Statewide Hazard Mitigation Planning Utilizing Risk MAP Products: A Case Study for Success in Missouri. Alicia Williams, CFM, Wood E&IS

Developing a Community Mitigation Program - Recipes for Success from Mecklenburg County. Katie Hermann, GISP, CFM, ESP Associates

Elevation Data & Datums 19

Moderator: David Knipe, PE, CFM, Indiana Dept of Natural Resources
Changing Flood Reference Elevations is Relative but it is a Big Deal! David Curtis, Ph.D., WEST Consultants

Digging for Datums and Aligning Aerial Imagery. Christine Gallagher, NOAA's National Geodetic Survey
The 3D Nation Elevation Requirements and Benefits Study - Preliminary Results. Ashley Chappell, NOAA

- J5 **Wait, You Want to Model What? 20**
Modeling Unique Features
 Moderator: Dan Brubaker, PE, CFM, North Carolina Dept of Public Safety
What Happens When the Bottom Drops Out? Bryan Martindale, PE, CFM, Knight E/A
Regional Flooding Challenges and Approaches – Huntington, WV Flood Mitigation Study. Ifeanyi Odigboh, PE, CPESC, CFM, ms consultants, inc.
Save Fame Studios: 2D Sinkholes with Floodways in Muscle Shoals, Alabama. Felipe Dias, EIT, CFM, Wood

- J6 **Risk Communication and Planning 21**
for Dams and Levees
 Moderator: Veronica Villalobos-Pogue, ACEM, CFM, Arkansas Natural Resources Commission
How A Multiple Dam EAP Table Top Exercise is a Win-Win Situation. Natalie Rogers, PE, CFM, FTN Associates, Ltd.
Assessment of USACE Collaborative Levee Flood Risk Communication Initiative: Challenges & Lessons Learned. Mary Weidel, PE, CFM, U.S. Army Corps of Engineers
Lessons Learned from 20+ Flood Response

J7

Plans. Sheila McKinley, AICP, CFM, Christopher B Burke Engineering, LLC

Post-Disaster Actions and Processes 22
 Moderator: Shana Udvary, CFM, Union of Concerned Scientists
The SBA Disaster Loan Program: Preparedness, Recovery, Insurance Requirements and Mitigation. Alejandro Contreras, U.S. Small Business Administration - Office of Disaster Assistance
Unveiling of the FEMA Coastal Disaster Data Playbook. Nicole Metzger, Atkins
Post-Disaster Data Analytics- Transforming Recovery Decision-Making. Mathew Mampara, PE, Dewberry

J8

Flood Map Change Processes 23
 Moderator: Ceil Strauss, CFM, Minnesota Department of Natural Resources
Advancements and New Initiatives Impacting MT-1 Letter of Map Change Processing. Todd Steiner, FEMA HQ
Using LiDAR to Support Letter of Map Amendments (LOMAs): What Submitters Need to Know. Matt Richards, CFM, Michael Baker Intl.
Those Maddening Approximate A Zones - Case Studies and Proposed Holistic Solutions. Cleighton Smith, PE, CFM, Taylor Wiseman & Taylor.

7:00-11:00

NETWORKING RECEPTION

Off-site

The Rock and Roll Hall of Fame, or "Rock Hall", as the locals call it, recognizes and archives the history of the best-known and most influential artists, producers, engineers, and other notable figures who have had some major influence on the development of rock and roll. Explore one of the most impressive collections of memorabilia ever assembled — from John Lennon's guitar to hip-hop pioneer Jam Master Jay's gold chains. Pre-registration required. Food and beverages included. Buses will be available for pick up and drop off at conference hotels if you prefer not to walk. **ATTENDEE/GUEST NAME BADGE AND TICKET MUST BE PRESENTED FOR ADMISSION**

Sponsored by: The Pew Charitable Trusts

ASFPM ANNUAL NATIONAL CONFERENCE

SAVE THE DATE
JUNE 7-11, 2020

ASFPMCONFERENCE.ORG/2020

